

REVERSO

OIL CHANGE SYSTEM AND PUMPS

Industrial Manual



Reverso Pumps, Inc.
201 SW 20th Street
Fort Lauderdale, FL 33315

Phone: (954) 522 - 0882
Fax: (954) 522 - 0456

www.reversopumps.com
info@reversopumps.com

0708

Page - 1 - GP-201 DC GEAR PUMP

Page - 2 - GP-301 DC GEAR PUMP

Page - 3 - GP-301 AC GEAR PUMP

Page - 4 - GP-302 DC GEAR PUMP

Page - 5 - GP-602 DC GEAR PUMP

Page - 6 - GP-602 AC GEAR PUMP

Page - 7 - GP-612 DC HEAVY DUTY GEAR PUMP

Page - 8 - AC-METERING GEAR PUMP

Page - 9 - DP SERIES HIGH FLOW DIESEL TRANSFER PUMP

Page - 10 - OP-6 IMPELLER PUMP

Page - 11 - PORTABLE PUMP SYSTEMS

Page - 12 - FP-301 FUEL PRIMING SYSTEM

Page - 13 - 80 DC SEPAR FUEL POLISHING SYSTEM

Page - 14 - 150 DC SEPAR FUEL POLISHING SYSTEM

Page - 15- 150 DC RACOR FUEL POLISHING SYSTEM

Page - 16 - 210 AC SEPAR FUEL POLISHING SYSTEM

Page - 17 - 600 NEMA 3R FUEL POLISHING SYSTEM

Page - 18 - 600 AC SEPAR FUEL POLISHING SYSTEM

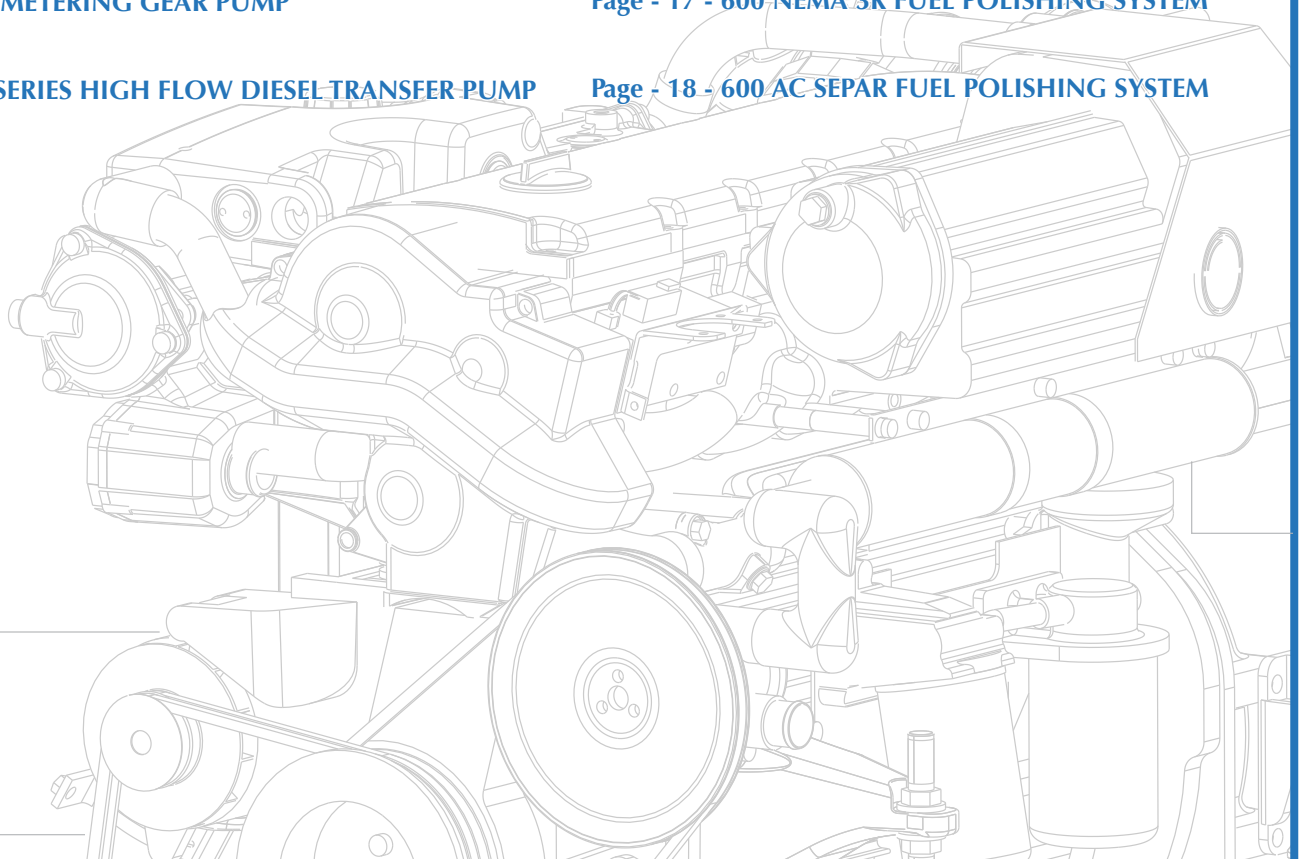

The GP-201 is a compact powerful self-priming DC gear pump. The bronze gears and stainless steel shaft enables the pump to move a variety of viscous and non-viscous fluids. The durable GP-201 fits easily in the tightest spaces. Available in both 12 and 24 volt DC and can be customized to suit a variety of applications.

Available w/optional base switch and fuse



Switch Functions Available

Single (*S) On - Off
Reversing (*R) on-off-on
Momentary (*M) On - Off

Technical Specification

Ports	3/8" Male NPT
Max work press	25 PSI
Max work temp	140 F
Flow Rate	1.5 L - 3 H GPM / 5.6 L - 11.35 H LPM
Self priming	1.5 feet (wet gears)
Lift	5 feet
Pump body	Brass
Gears	Bronze
Shaft	Stainless steel
Seal	Fluoroelastomer lip seal
Motor	DC - 12v or 24v
Fuse/Breaker	12v - 10 amp 24v - 5 amp

Model	A	B	C	D	WEIGHT
GP-201-DC	5.04"	3.15"	2.87"	1.50"	2lbs/.91kg

Ordering Specifications

Model _____ GP 201 *S/R/M 12/24 **L/H
 Pump _____
 Switch Base Optional _____
 Voltage _____
 Motor Speed _____

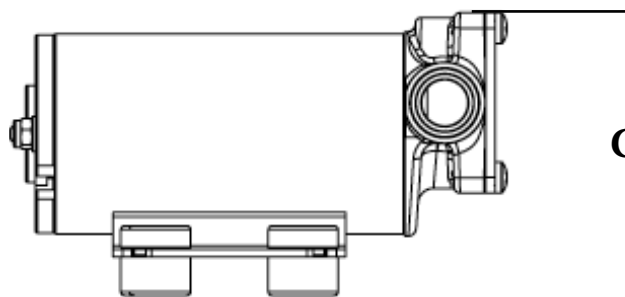
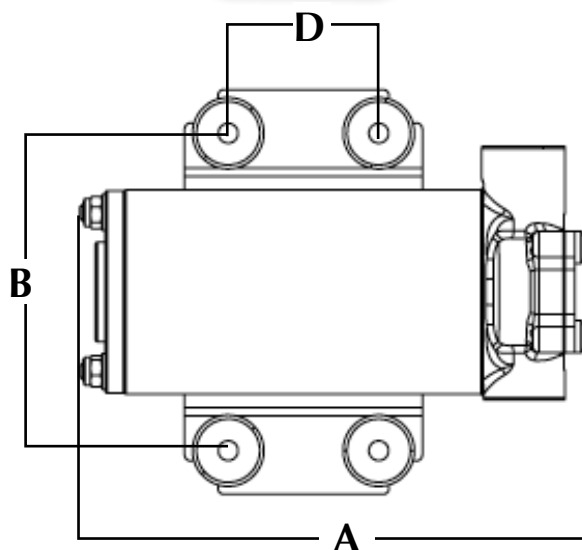

Drawing dimensions in INCHES for reference only
 Technical drawings available upon request

• **Base Option: (*S) On-Off/ (*R) Reversing/ (*M) Momentary • Motor Speed: (**L/H) Low/High.**

The GP-301 is a compact powerful self-priming DC gear pump. The bronze gears and stainless steel shaft enables the pump to move a variety of viscous and non-viscous fluids. The durable GP-301 fits easily in the tightest spaces. Available in both 12 and 24 volt DC and can be customized to suit a variety of applications.

Available w/optional base switch and fuse



Switch Functions Available

Single (*S) On - Off
 Reversing (*R) on-off-on
 Momentary (*M) On - Off

Technical Specification

Ports	3/8" Male NPT	
Max work press	25 PSI	
Max work temp	140 F	
Flow Rate	2.5 L-3.5 H GPM / 9.46 L-13.25 H LPM	
Self priming	5 feet (wet gears)	
Lift	10 feet	
Pump body	Brass	
Gears	Bronze	
Shaft	Stainless steel	
Seal	Fluoroelastomer lip seal	
Motor	DC 12v or 24v	
Fuse/Breaker	12v - 10 Amp	24v - 5 Amp

Model	A	B	C	D	WEIGHT
GP-301	5.44"	3.06"	3.00"	1.53"	6 lbs/2.75 kg

Ordering Specifications

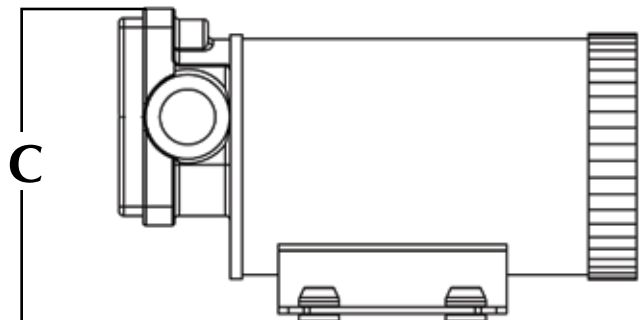
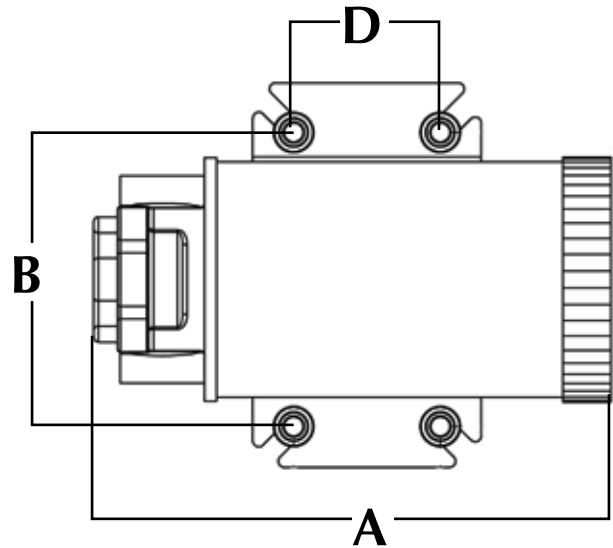
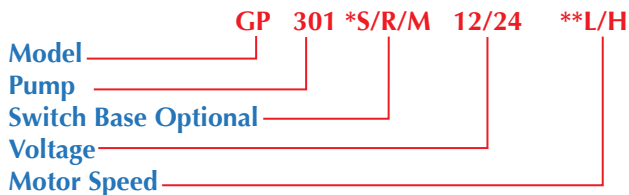

Drawing dimensions In INCHES for reference only Technical drawings available upon request

• **Base Option: (*S) On-Off/ (*R) Reversing/ (*M) Momentary** • **Motor Speed: (**L/H) Low/High.**

The GP- 301 AC is a powerful self-priming AC gear pump able to move light viscous liquids up to 50 feet. The motor is reversible self-ventilated and is both UL and CE certified. Available both in 110/220v AC, and can be customized to suit a variety of applications.

Available w/optional base switch and fuse



Switch Functions Available

Single (*S) On - Off
Reversing (*R) on-off-on

Technical Specification

Ports	3/8" Male NPT
Volt	110v-60 Hz / 220v-50 Hz
Watt	140@110v AC 60Hz
Flow Rate	3.6 GPM / 13.6 LPM
Self priming	5 feet (wet gears)
Lift	100 feet (water)
Pump body	Brass
Gears	Bronze
Shaft	Stainless steel
Seal	Fluoroelastomer lip seal
Motor	AC Self Ventilated
Insulation	IP54
Fuse/Breaker	110v/220v - 5 Amp

Model	A	B	C	WEIGHT
GP-301-AC	10.37"	4.54"	6.37"	10 lbs/4.54 kg

Ordering Specifications

Model _____ GP 301 *S/R **10/20
 Pump _____
 Switch Base Option _____
 Voltage _____

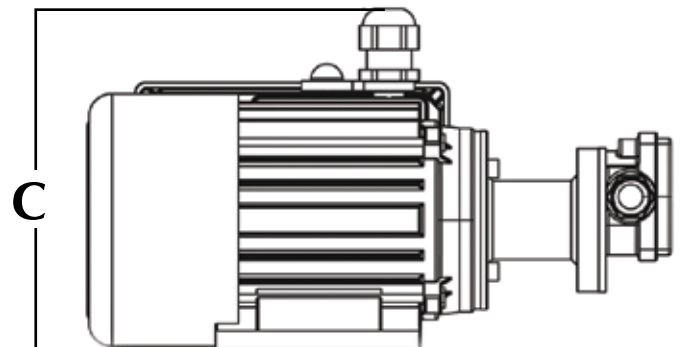
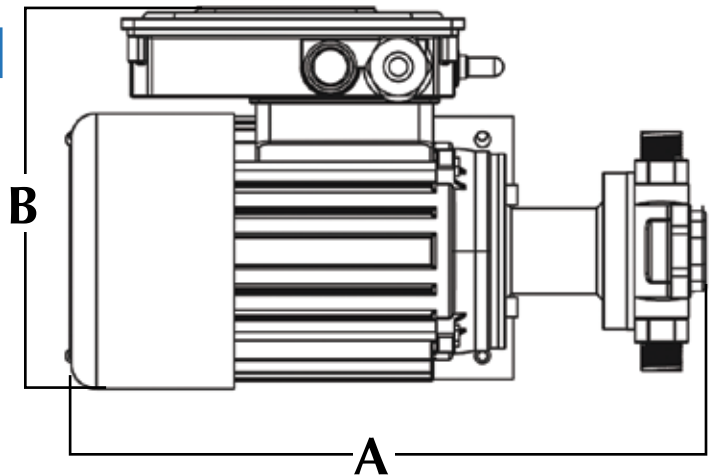

Drawing dimensions in INCHES for reference only Technical drawings available upon request

• Base Option: (*S) On-Off/ (*R) Reversing

(**10)110V/(**20)220V

The GP-302 is a compact powerful self-priming DC gear pump. The bronze gears and stainless steel shaft enables the pump to move a variety of viscous and non-viscous fluids. The durable GP-302 fits easily in the tightest spaces. Available in both 12 and 24 volt DC and can be customized to suit a variety of applications.

Available w/optional base switch and fuse



Switch Functions Available

Single (*S) On - Off
Reversing (*R) on-off-on
Momentary (*M) On - Off

Technical Specification

Ports	3/8" Male NPT
Max work press	40 PSI
Max work temp	140 F
Flow Rate	2.5 L-3.5 H GPM / 9.46 L-13.25 H LPM
Self priming	5 feet (wet gears)
Lift	30 feet
Pump body	Brass
Gears	Bronze
Shaft	Stainless steel
Seal	Fluoroelastomer lip seal
Motor	DC 12v or 24v
Fuse/Breaker	12vL-10 Amp 12vH-15Amp 24v-7.5Amp

Model	A	B	C	D	WEIGHT
GP-302	5.87"	3.79	3.79"	2.25"	7 lbs/3.18 kg

Ordering Specifications

Model _____ GP 302 *S/R/M 12/24 **L/H
 Pump _____
 Switch Base Optional _____
 Voltage _____
 Motor Speed _____

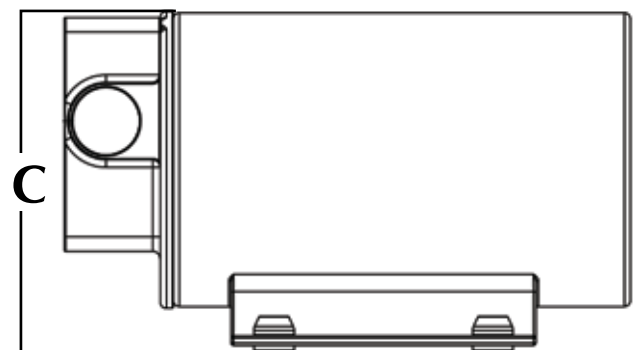
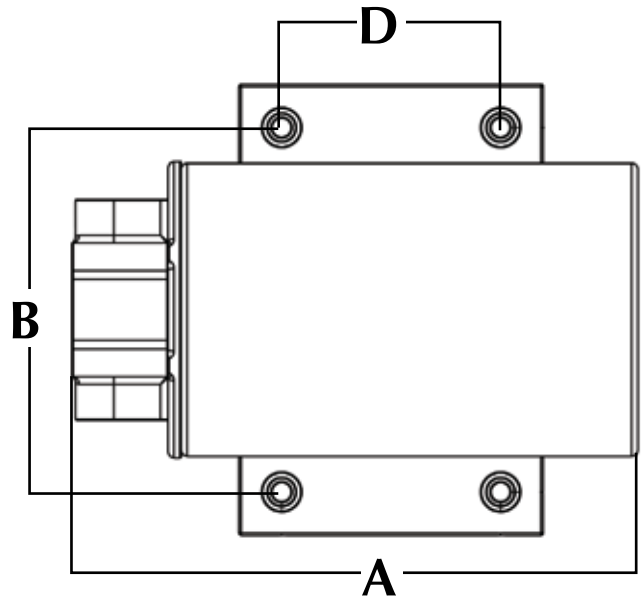

Drawing dimensions in INCHES for reference only Technical drawings available upon request

• **Base Option: (*S) On-Off/ (*R) Reversing/ (*M) Momentary** • **Motor Speed: (**L/H) Low/High.**

The GP- 602 is a compact powerful electric DC gear pump. The bronze gears and stainless steel shaft is able to move low viscosity fluids **NOT** designed for heavy oils. The durable GP-602 combines a small physical size with a high flow capacity. Available in both 12 and 24 volt and can be customized to suit a variety of diesel fuel transfer applications.

Available w/optional base switch and fuse



Switch Functions Available

Single (*S) On - Off
Reversing (*R) on-off-on
Momentary (*M) On - Off

Technical Specification

Ports	1/2" Male NPT
Max work temp	140 F
Flow Rate	6 GPM / 22.7 LPM
Self priming	5 feet (wet gears)
Lift	60 feet (water)
Pump body	Brass
Gears	Bronze
Shaft	Stainless steel
Seal	Fluoroelastomer lip seal
Motor	DC 12v or 24v
Fuse/Breaker	12v - 15 Amp 24v - 10 Amp
Fluid Viscosity	31-80 SSU

Model	A	B	C	D	WEIGHT
GP-602	7.08"	3.98"	4.00"	2.25"	8 lbs/3.63 kg

Ordering Specifications

Model _____
 Pump _____
 Switch Base Option _____
 Voltage _____

GP 602 *S/R/M 12/24

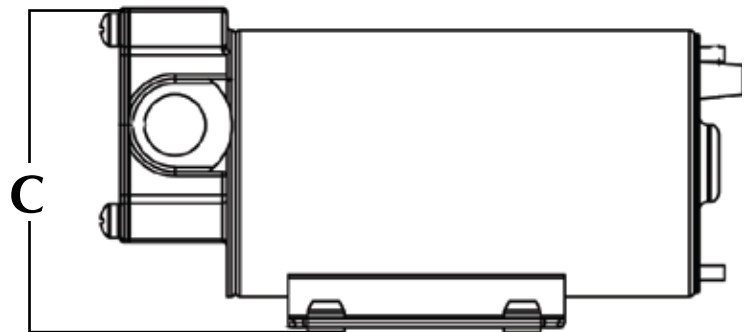
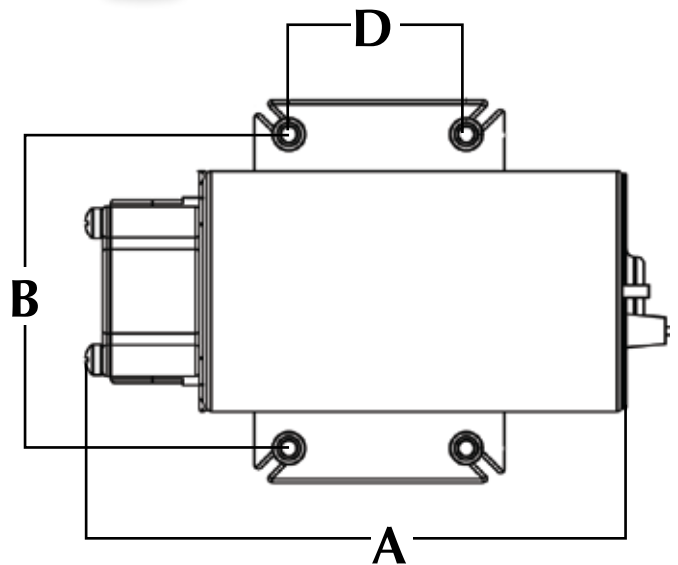

Drawing dimensions in INCHES for reference only Technical drawings available upon request

- **Base Option: (*S) On-Off/ (*R) Reversing/ (*M) Momentary**

The GP-602 AC is a powerful self-priming AC gear pump able to move light viscous liquids up to 100 feet. The motor is reversible self-ventilated and is both UL and CE certified. Available in both 110/220v with Soft Start inverter, can be customized to suit a variety of applications.



Available w/optional base switch and fuse



Switch Functions Available

For 110v Version Only*
 Single (*S) On - Off
 Reversing (*R) on-off-on

Technical Specification

Ports	1/2" Male NPT		
Volt	110-60 Hz / 220-50 Hz		
Watt	550@110v AC 60Hz		
Flow Rate	8.5 GPM / 32.18 LPM		
Self priming	20 feet (wet gears)		
Lift	120 feet (water)		
Pump body	Brass		
Gears	Bronze		
Shaft	Stainless steel		
Seal	Fluoroelastomer lip seal		
Motor	AC Self Ventilated		
Insulation	IP54		
Fuse/Breaker	110v - 10 Amp	220v(3ph) - 5 Amp	

Model	A	B	C	WEIGHT
GP-602-AC	12.56"	5.36"	7.56"	14 lbs/6.4 kg

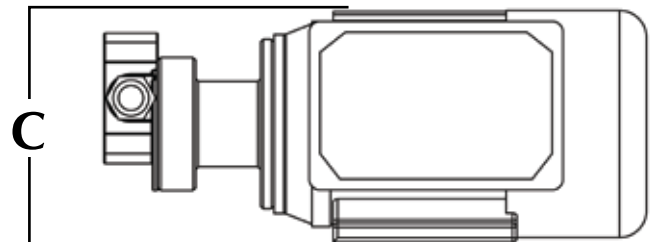
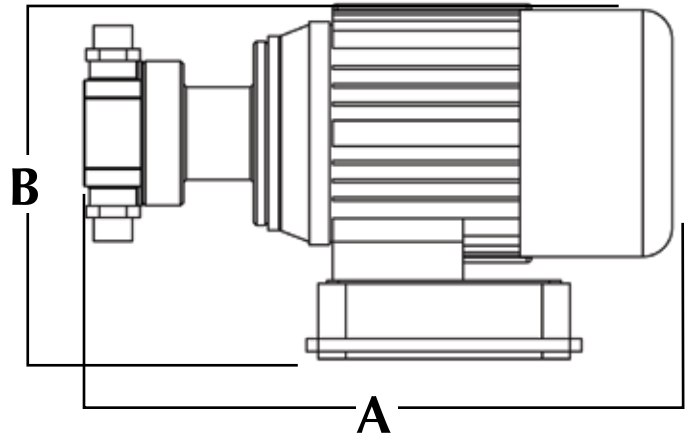

Ordering Specifications

Model _____ GP 602 *S/R **10/20
 Pump _____
 Switch Base Option _____
 Voltage _____

Drawing dimensions In INCHES for reference only Technical drawings available upon request

• Base Option: (*S) On-Off/ (*R) Reversing (Each available with 110v only) 220v switch option - contact us (**10)110V/(**20)220V

The GP-612 is a compact powerful self-priming DC gear pump. The brass gears and stainless steel shaft enables the pump to move a variety of viscous and non-viscous fluids. The durable GP-612 fits easily in the tightest spaces. Available in 12 or 24 volt DC and can be customized to suit a variety of applications. Low speed is recommended for oil and high speed for diesel fuel.

Available w/optional base switch and fuse



Switch Functions Available

Single (*S) On - Off
Reversing (*R) on-off-on

Technical Specification

Ports	1/2" Male NPT	
Max work press	40 PSI	
Max work temp	140 F	
Flow Rate	Low- 4 gpm	High- 10.5 gpm
Self priming	Low- 6.5ft	High- 13ft
Lift	Low- 6.5ft	High- 13ft
Pump body	Brass	
Gears	Brass	
Shaft	Stainless steel	
Seal	Fluoroelastomer lip seal	
Motor	DC 12v or 24v	

Pump Model	Fuse/Breaker
GP-612-12	30 Amp.
GP-612-24	15 Amp.

Model	A	B	C	D	WEIGHT
GP-612	7.5"	3.75"	4.0"	2.5"	9 lbs.

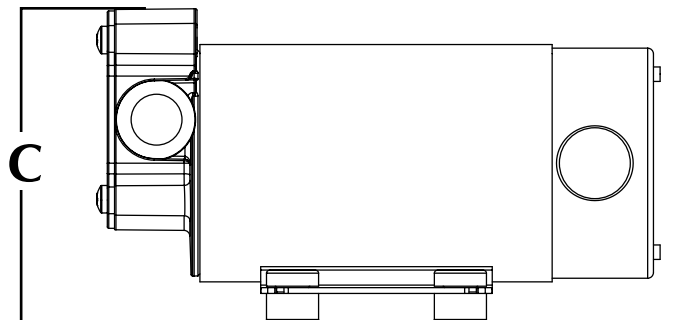
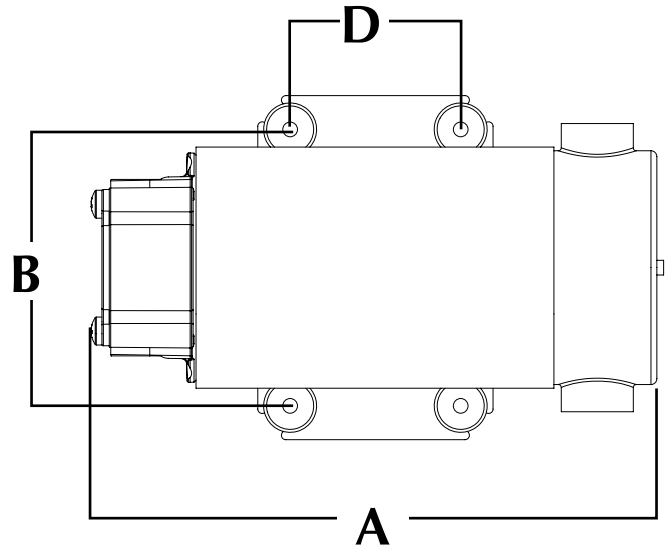
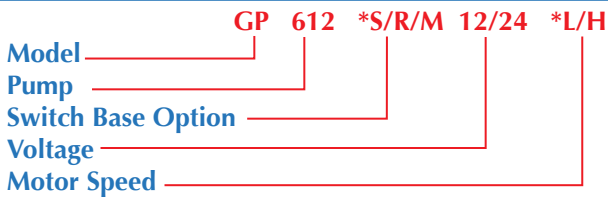

Drawing dimensions In INCHES for reference only Technical drawings available upon request

• **Motor Speed: (*L/H) Low/High.** • **Base Option: (*S) On-Off/ (*R) Reversing**

The metering Gear Pump combines our powerful reversible gear pump and the AC driver for flow control. This system allows for precise flow control and the ability to reverse flow all in one compact unit. Available in both 110/220v AC can be customized to suit a variety of applications.

- **Power Start :** Provides more than 200% starting torque which ensures startup of high frictional loads.
- **Electronic Inrush Current Limit:** Eliminates harmful inrush AC line current during repetitive pump startup.
- **Regeneration Protection:** Eliminates tripping due to rapid deceleration of high inertial loads.
- **Ride Through:** Provides a smooth recovery to the previous set speed during a momentary power loss.
- **Diagnostic LEADS:** Power on (POWER) and control status (STATUS)
- **Protection Features:** Under voltage and over voltage protection. MOV input transient protection. Micro controller self-monitoring and auto-reboot. Short circuit protected phase-to-phase at motor.

Technical Specification

Ports	1/2" Male NPT
Volt	110v-50/60Hz / 220v-50/60Hz
Watt	600
Amp.	30 PSI 4.8 Amps - 60 PSI 7.5 Amps
Self priming	10 feet (wet gears)
Lift	100 feet (water)
Pump body	Brass
Gears	Bronze
Shaft	Stainless steel
Seal	Fluoroelastomer lip seal
Motor	AC Self Ventilated

Pump Model Fuse/Breaker Adj. Flow Rate

GP30110V6	5 Amp.	.5-3.5GPM / 1.9-13.25 LPM
GP30120V6	5 Amp.	.5-3.5GPM / 1.9-13.25 LPM
GP60210V6	10 Amp.	2-8.5GPM / 7.6-32.18 LPM
GP60220V6	10 Amp.	2-8.5GPM / 7.6-32.18 LPM

Model _____ **GP 301/602 *10/20 V6**
 Pump _____
 Voltage _____
 Metering _____

GP60210V6 as shown

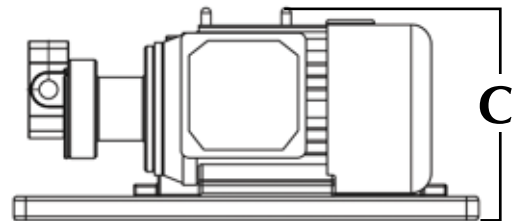
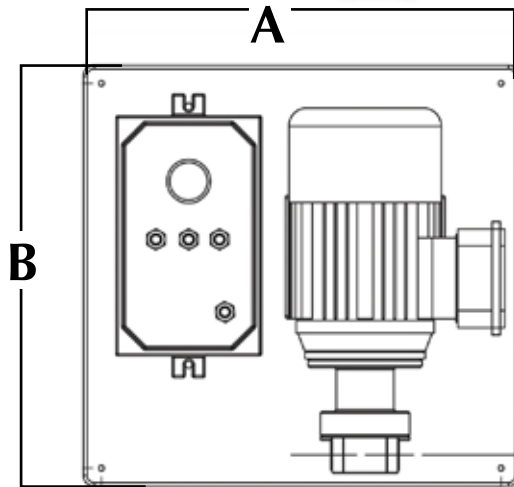

Drawing dimensions In INCHES for reference only Technical drawings available upon request

Model	A	B	C	WEIGHT
AC-301	14.00"	12.50"	6.25"	20 lbs/9.07 kg
AC-602	15.00"	14.50"	6.62"	32 lbs/14.5 kg

- **Base Option: (*10)110V/(*20)220V**

The DP-Series are compact, powerful AC or DC diesel transfer pumps. The DP series is specifically designed for the transfer of diesel. Ideal for high flow transfer applications in between storage tanks. AC versions are reversible and come with a variable speed control as pictured.

Technical Specification

	DP 15 DC/AC	DP 20 DC/AC	DP 30 DC/AC
Ports	# 16 Male JIC	# 16 Male JIC	# 20 Male JIC
Max lift	39'/60'	60'/60'	72'/72'
Fluid temp. range	35°F-160°F	35°F-160°F	35°F-160°F
Flow Rate at 0' level	15 GPM	20 GPM	32 GPM
Self priming*	18'	20'	20'
Pump body	Bronze	Bronze	Bronze
Impeller	Bronze	Bronze	Bronze
Shaft	316 Stainless steel	316 Stainless steel	316 Stainless steel
Seal	Nitrile	Nitrile	Nitrile
Motor	DC/AC single phase	DC/AC single phase or 3-phase	DC/AC single phase or 3-phase
Continous Duty	Yes	Yes	Yes

Amperage

	DP 15	DP 20	DP 30
DC	24v@22amp	24v@38amp	24v@45amp
AC	110/220v@10amp 50/60hz@10amp	110/220v@10amp 50/60hz@10amp	110v/220v@15amp 50/60hz@15amp

Weight

	Motor	Controller
DP-15-AC	20 lbs/9.07 kg	8 lbs/3.6 kg
DP-15-DC	22 lbs/10 kg	N/A
DP-20-AC	28 lbs/12.7 kg	8 lbs/3.6 kg
DP-20-DC	32 lbs/14.5 kg	N/A
DP-30-AC	42 lbs/19 kg	12lbs/5.5 kg
DP-30-DC	46 lbs/21 kg	N/A

Ordering Specifications

Model **DP** **15/20/30** ***01/02/03**
 Pump _____
 Motor _____



Top view

Pump must be mounted in horizontal position ONLY.

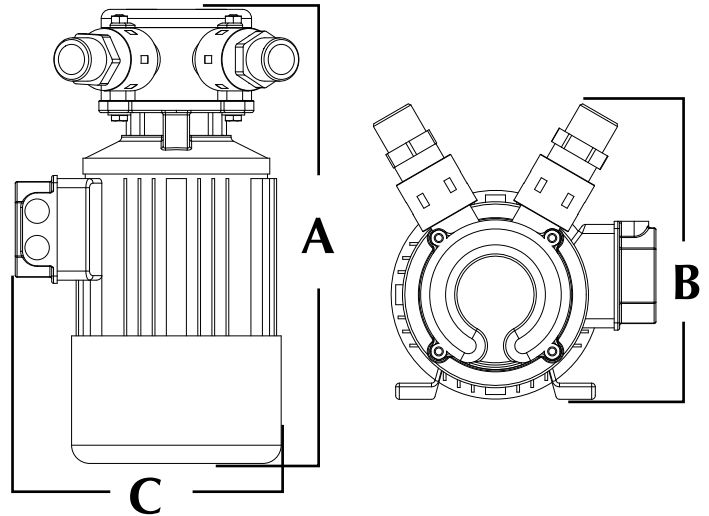

*Self priming after initial use. Must be primed before 1st use.

Drawing dimensions in INCHES for reference only Technical Drawings available upon request

Model	A	B	C
DP 15 AC	12.6"	6.5"	8.4"
DP 15 DC	13.5"	6.5"	7.0"
DP 20 AC	14.2"	7.8"	9.1"
DP 20 DC	16.0"	7.8"	8.0"
DP 30 AC	15.2"	7.8"	9.2"
DP 30 DC	20.5"	8.3"	8.6"

• Base Option: (*01) 110v / (*02) 220v / (*03) 24v

The Reverso OP-6 is a useful transfer pump suitable for oil, diesel fuel or water. The OP-6 can transfer hot or cold oil quickly and cleanly to and from the engine oil pan. Both ports are 3/8" int. and 3/4"(Ext) garden hose thread fittings. The three position switch has a safety lock that prevents accidental activation. The switch is directionally oriented (flow is in direction of switch) for easy operation. The pump will generate up to 15 PSI of pressure. Meets ISO 8846 standards.

Technical Specification

Ports	(Ext) M 3/4" Hose (Int) F 3/8" NPT
Amp.	7A@12v - 3A@24v
Flow Rate	3.0 GPM / 11.35 LPM
Impeller	Nitrile (Standard) Fluoroelastomer (Optional)
Self priming	3 feet
Lift	10 feet
Seal	Nitrile (Standard) Fluoroelastomer (Optional)
Motor	DC 12/24v

Impellers & Gaskets

360010	Impeller (Nitrile) use for oil or water transfer
360014	Impeller (Fluoroelastomer) use for diesel fuel transfer
360120	Gasket for OP-6

Repair Kits-Contains: Sets composed of impeller + gasket

SRK-360	1 Oil/water set
SRK-370	1 Diesel/oil set

Rebuild Kits-Contains: Impeller+gasket + seals

SRK-361	1 Oil/water set
SRK-371	1 Diesel/oil set

Model	A	B	C	WEIGHT
OP-6	9.59"	3.25"	3.67"	6 lbs/2.72kg
OP-6FV	9.59"	3.25"	3.67"	6 lbs/2.72kg

Ordering Specifications

Model OP 6 FV 12/24
 Pump
 Fluoroelastomer Impeller
 Voltage

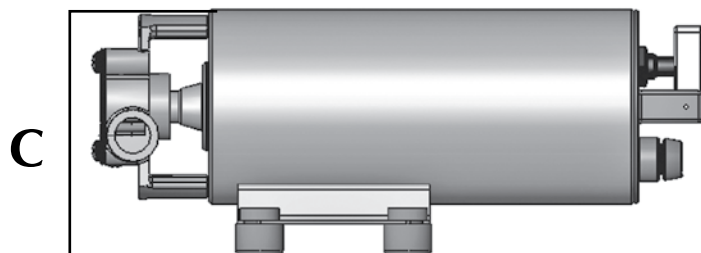
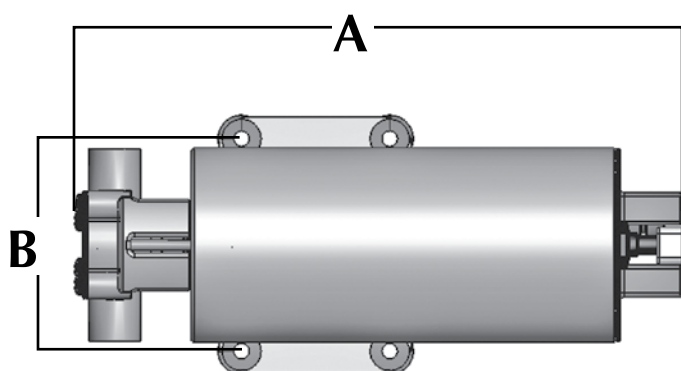

Drawing dimensions In INCHES for reference only Technical drawings available upon request

Inside the OP-6

- Reversible
- Self-priming
- Chrome plated brass head
- Built in switch guard
- Fused at the motor
- Easily changed Impeller
- "CE" certified



BENEFITS

- Reversible self-priming
- Compact size with exceptional flow rate (3GPM/11 LPM)
- Powerful reversible pumps specially designed to be used with oils.

Gear Pump Series

Technical Specification

Ports	3/8" Male JIC
Amp.	8.8A@12v-5.3A@24v
Flow Rate	3 GPM / 11.35 LPM
Self priming	5 feet (wet gears)
Lift	15 feet
Pump body	Brass
Gears	Bronze
Shaft	Stainless Steel
Seal	Fluoroelastomer lip seal
Motor	DC 12v or 24v
Weight	301BKT-6 lbs/2.75 kg 301P-6 lbs/2.75kg

Impeller Pump Series

Technical Specification

Ports	3/4" M Hose & 3/8" F NPT
Amp. (load 20 PSI)	7A@12v-2.9A@24v
Flow Rate	3 GPM 11.35 LPM
Self priming	3 feet
Lift	10 feet
Impeller	Nitrile (Standard) Fluoroelastomer (Optional)
Working Press	0-15 PSI
Seal	Nitrile Rubber
Motor	DC 12v or 24v
Weight	8 lbs/3.63 kg

GP-301BKT

6' Power cord made of marine grade wire with red/black battery clips

GP-301 brass gear pump with a durable 12volt DC motor, pump head is made of brass, gears are of bronze, and stainless steel shaft.



GP-301P

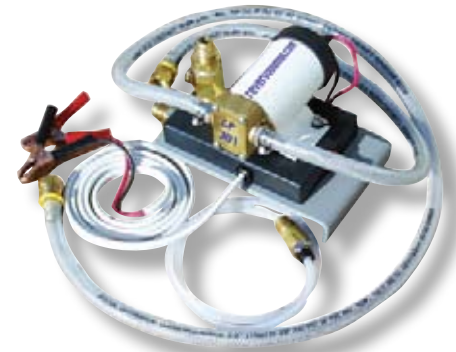

OP-700

King Starboard pump base include connector holders to avoid oil spillage during unit transport.

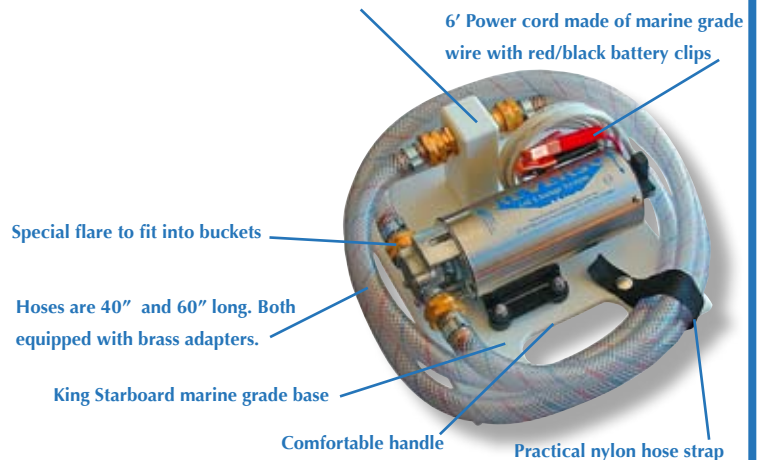

The Reverso Fuel Priming System pumps fuel into the fuel lines, purging trapped air in the main feeding line and from primary filters, secondary filters and engines. To protect delicate fuel systems, all primers have integral pressure relief valves which are factory set to deliver the proper fuel pressure for each engine. Engine models available: MTU, MAN, Detroit 2000 / 4000 series etc.

•The Fuel Primer® is an easy installation:

As simple as splitting the fuel line and connecting each end of the fuel line to each side of the unit.

•The Fuel Primer® is easy to operate:

- a) Close valve (on primer), open the air vent on filters or engine and flip the switch.
- b) When lines are purged, close the vents and open valve (on primer).

•The Fuel Primer® has small footprint



Technical Specification

Ports	1" NPT Ports
Valve	1" Full Flow
Amp.	10A@12v - 5A@24v
Size	10" x 11.38" x 4.36"
Weight	13 lbs/5.9 kg
Optional	Remote switch with extension cord

Typical Fuel Primer Installation



Ordering Specifications

12	12 Volt
24	24 Volt
P	*Remote Control (leave blank for no remote)
S	Switch (on the electric box)
N	No Switch (on the electric box)
L	Left to Right (Fuel flow direction)
R	Right to Left (Fuel flow direction)
15	Preset valve pressure (Specify engine)
22	Preset valve pressure (Specify engine)
411160*	Part Number for Pendant Switch

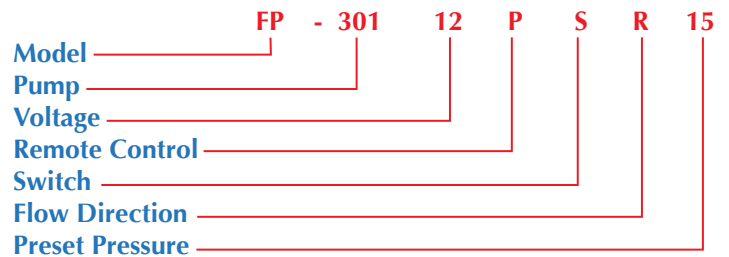

- Unique service filter alarm
- Eliminates the build-up of algae and water in your tanks
- Reduces cost of filter maintenance
- 99% water and particulate removal
- Compact Design
- Optional magnetic fuel conditioner
- 7-Day Timer

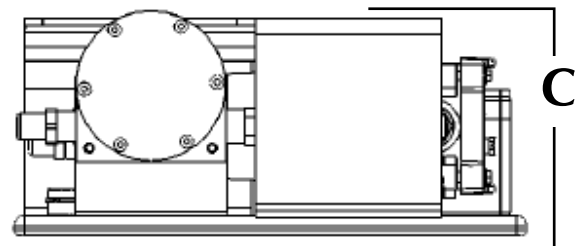
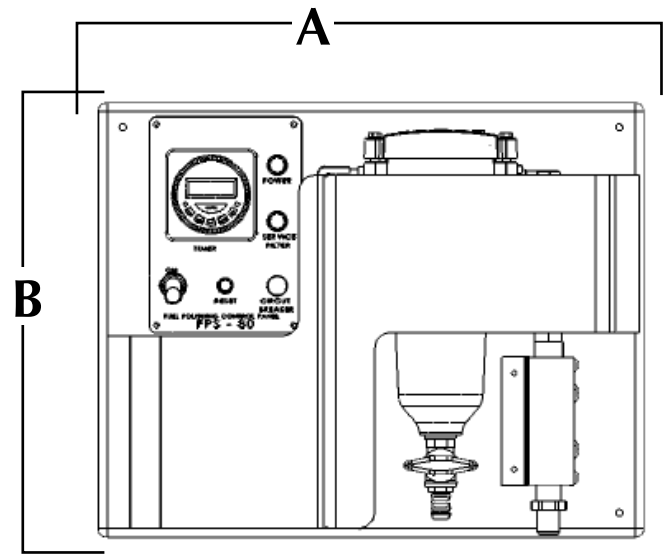
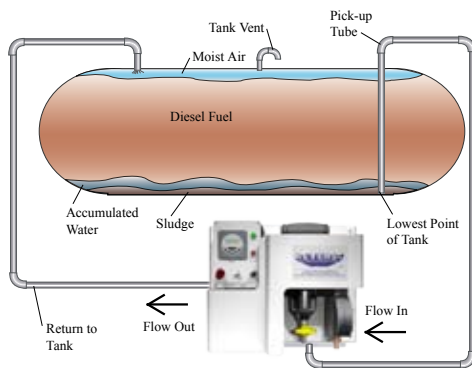

Technical Specification

Inlet	1/2" #8 JIC Male
Outlet	1/2" #8 JIC Male
Volt	12 or 24v DC
Amp.	3A@12v - 1.5A@24v
Flow Rate	80 GPH / 303 LPH
Max Lift	4 Feet Vertical
Pump Body	Brass
Gears	Bronze
Shaft	Stainless Steel
Seal	Fluoroelastomer lip seal
Motor	DC Perm. Magnets

Part Number	Description
FPS80S17	Reverso 12v Separ
FPS80S18	Reverso 24v Separ
FPS80S19	12v without Fuel Conditioner
FPS80S20	24v without Fuel Conditioner

Model	A	B	C	WEIGHT
FPS-80	17.00"	13.50"	5.50"	21lbs/9.5kg

Drawing dimensions in INCHES for reference only Technical drawings available upon request

- Unique service filter alarm
- Eliminates the build-up of algae and water in your tanks
- Reduces cost of filter maintenance
- 99% water and particulate removal
- Compact Design
- Optional magnetic fuel conditioner

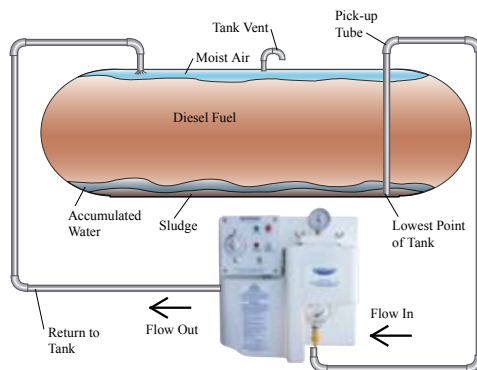

Technical Specification

Inlet	1/2" #8 JIC Male
Outlet	1/2" #8 JIC Male
Volt	12 or 24v DC
Amp.	10A@12v - 5A@24v
Flow Rate	150 GPH / 567.8 LPH
Self Priming	5 Feet (System Primed)
Max Lift	10 Feet
Pump Body	Brass
Gears	Bronze
Shaft	Stainless Steel
Seal	Fluoroelastomer lip seal
Motor	DC Perm. Magnets

Part Number Description

FPS150S19	Reverso 12v Separ
FPS150S20	Reverso 24v Separ
FPS150S21	12v without Fuel Conditioner
FPS150S22	24v without Fuel Conditioner

Model	A	B	C	WEIGHT
FPS-150S	17.00"	18.25"	6.09"	25 lbs/11.34 kg

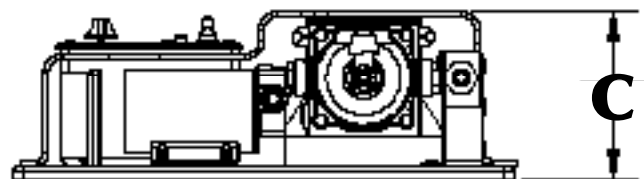
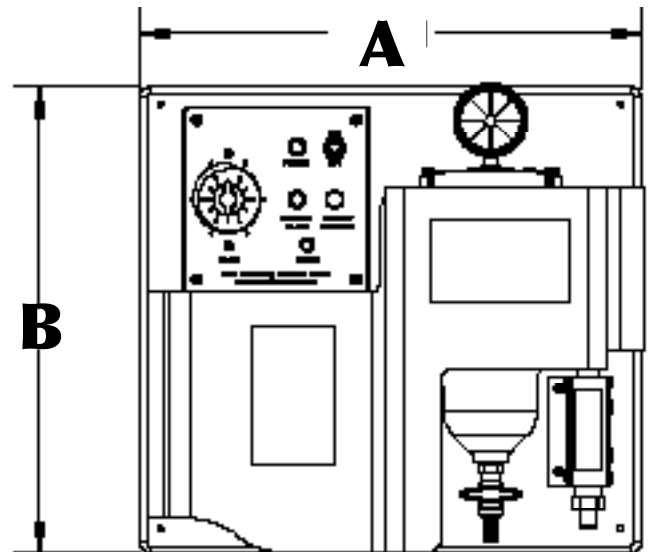

Drawing dimensions in INCHES for reference only Technical drawings available upon request

- Unique service filter alarm
- Eliminates the build-up of algae and water in your tanks
- Reduces cost of filter maintenance
- Features genuine Racor® Aqua Block® element
- Optional magnetic fuel conditioner

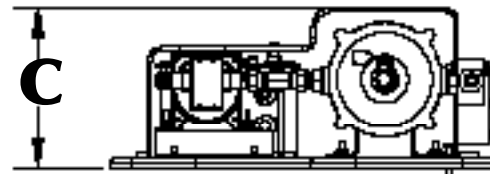
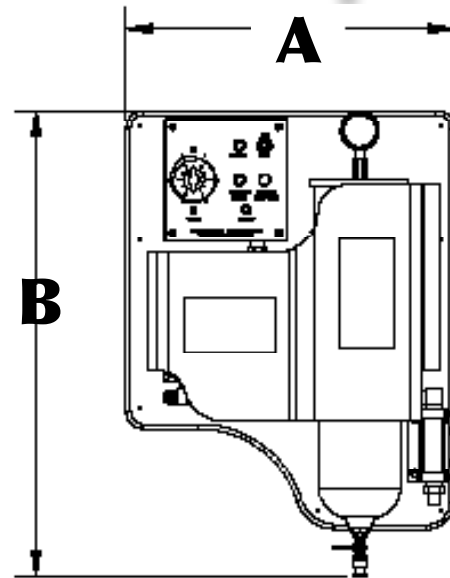
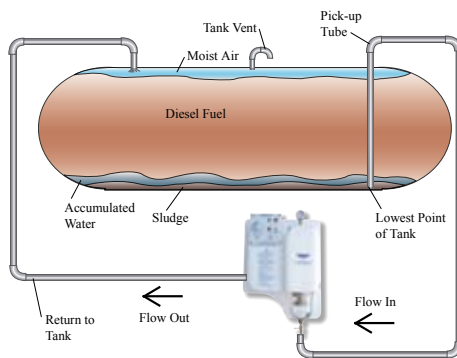

Technical Specification

Inlet	1/2" #8 JIC Male
Outlet	1/2" #8 JIC Male
Volt	12 or 24v DC
Amp.	10A@12v - 5A@24v
Flow Rate	150 GPH / 567.8 LPH
Self Priming	5 Feet (System Primed)
Max Lift	10 Feet
Pump Body	Brass
Gears	Bronze
Shaft	Stainless Steel
Seal	Fluoroelastomer lip seal
Motor	DC Perm. Magnets

Part Number Description

FPS150R17	12v Racor System
FPS150R18	24v Racor System
FPS150R19	12v Racor without fuel conditioner
FPS150R20	24v Racor without fuel conditioner

Model	A	B	C	WEIGHT
FPS-150R	18.00"	25.59"	7.50"	38lbs 17.24kg

Drawing dimensions In INCHES for reference only Technical drawings available upon request

- Unique service filter alarm
- Eliminates the build-up of algae and water in your tanks
- Reduces cost of filter maintenance
- 99% water and particulate removal
- Compact Design
- Optional magnetic fuel conditioner

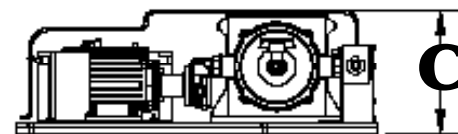
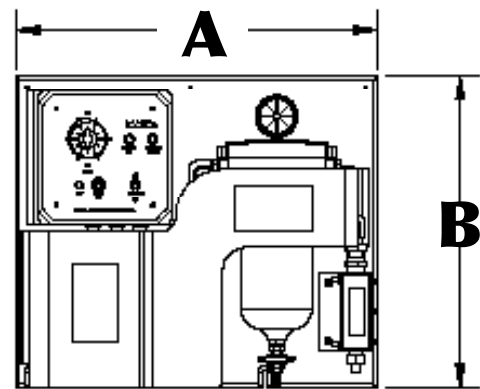
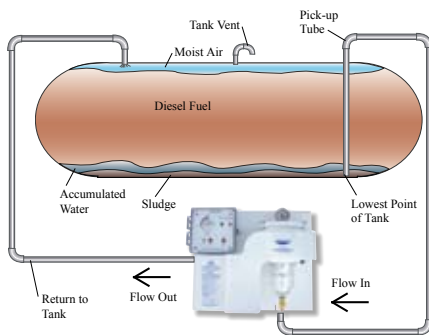

Technical Specification

Inlet	1/2" #8 JIC Male
Outlet	1/2" #8 JIC Male
Volt	110 or 220v AC
Amp.	3A@110v - 1.4A@220v
Watts	140
Flow Rate	210 GPH / 795 LPH
Self Priming	5 Feet (System Primed)
Max Lift	30 Feet
Pump Body	Brass
Gears	Bronze
Shaft	Stainless Steel
Seal	Fluoroelastomer lip seal
Motor	AC Perm. Magnets

Part Number	Description
FPS210S35	Reverso 110v Separ
FPS210S36	Reverso 220v Separ
FPS210S37	110v without Fuel Conditioner
FPS210S38	220v without Fuel Conditioner
FPS210S11	110v on cart
FPS210S12	220v on cart

Model	A	B	C	WEIGHT
FPS-210	23.25"	20.00"	7.72"	60 lbs/27.22 kg
FPS-210 cart	31.38"	41.29"	23.01"	150 lbs/68 kg

Drawing dimensions in INCHES for reference only.
Technical drawings available upon request.

Available on a
portable cart



- Unique service filter alarm
- Eliminates the build-up of algae and water in your tanks
- Reduces cost of filter maintenance
- 99% water and particulate removal
- Compact Design
- Vented NEMA 3R Enclosure
- 7 day timer feature

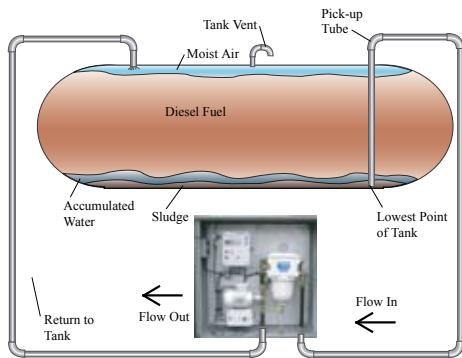

Technical Specification

Volt	110 or 220v AC
Amp.	4.8 Amps - 7.5 Amps
Watts	750
Flow Rate	600 GPH / 2271 LPH
Pump Body	Brass
Gears	Bronze
Shaft	Stainless Steel
Seal	Fluoroelastomer lip seal
AC Motor	110/220v 50/60 HZ
Weight	200 lbs/91kg

Self Ventilated Continuous Duty Motor overload protected

Harsh Environment Enamel Protected

Part Number Description

FPS-600S02	220v Enclosure unit
FPS-600S02-01	110v Enclosure unit

Filter elements available:

04010	- 10 Micron
04030	- 30 Micron (Standard)
04060 S	- 60 Micron Stainless Steel

Model	A	B	C	D	Weight
FPS-600S02	36.00"	36.00"	47.00"	11.00"	200 lbs/91kg
FPS-600S02-01	36.00"	36.00"	47.00"	11.00"	200 lbs/91kg

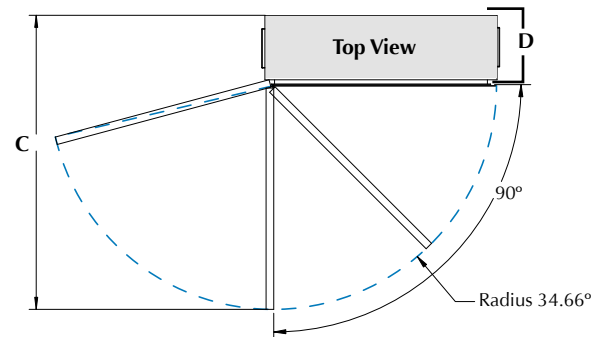
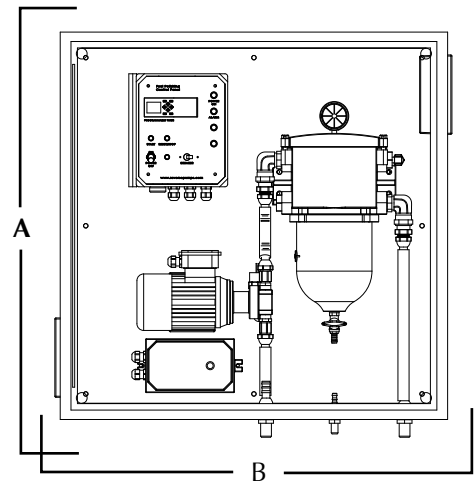

Drawing dimensions in INCHES for reference only Technical drawings available upon request

- Eliminates the build-up of algae and water in your tanks
- Reduces cost of filter maintenance
- 99% water and particulate removal
- Portable Design
- Unique shutdown alarms for high vacuum, pressure, and water

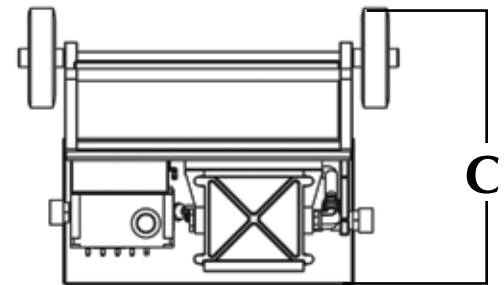
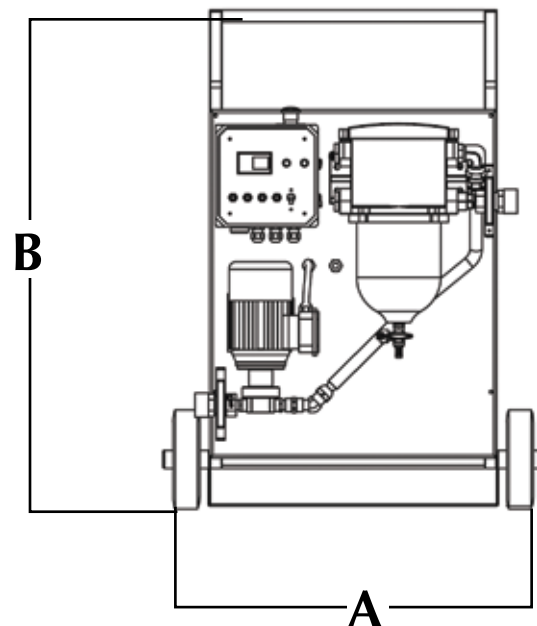
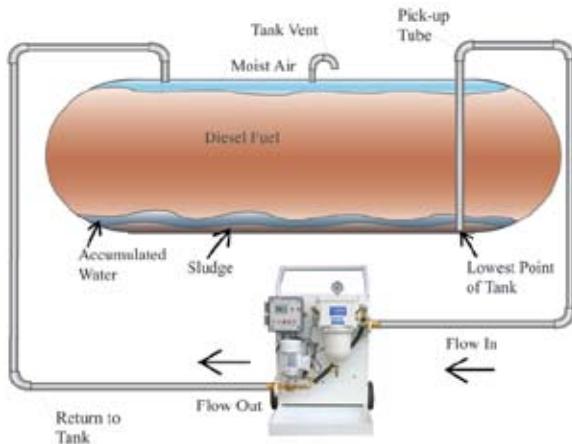

Technical Specification

Volt	110v AC
Amp.	4.8 Amps - 7.5 Amps
Watts	750
Flow Rate	600 GPH / 2271 LPH
Pump Body	Brass
Gears	Bronze
Shaft	Stainless Steel
Seal	Fluoroelastomer lip seal
AC Motor	110v 50HZ
Weight	175 lbs/80 kg

Self Ventilated Continuous Duty Motor overload protected
Harsh Environment Enamel Protected

Part Number Description

FPS-600S01	110v portable system
------------	----------------------

Filter elements Available: 600

04010	- 10 Micron
04030	- 30 Micron (Standard)
04060 S	- 60 Micron Stainless Steel

Model	A	B	C	WEIGHT
FPS-600S01	31.38"	41.29"	23.01"	175 lbs/80 kg

Drawing dimensions In INCHES for reference only Technical drawings available upon request