

# Compact C Range

**“A competitively priced progressing cavity pump, with a compact construction and maximum performance characteristics”.**

## Typical Applications

<b>Capacity</b>	up to 990 gpm	<ul style="list-style-type: none"> <li>• Domestic and industrial effluent</li> <li>• Hydrated lime slurry</li> </ul>
<b>Pressure</b>	up to 350 psi	<ul style="list-style-type: none"> <li>• Sludge</li> <li>• Shear sensitive latex emulsion</li> </ul>
<b>Temperature</b>	14°F up to 212°F	<ul style="list-style-type: none"> <li>• Milk curds, sauces, fruit juices</li> <li>• Industrial chemicals and detergents</li> <li>• Starch slurries</li> <li>• Coating clays, gypsum and silicate</li> <li>• Paper stocks</li> <li>• Agricultural slurries</li> </ul>

### Compact unit

As the drive forms an integral part of the unit, the pump is ideal for space-saving installations.

### Materials of construction

Available in cast iron or stainless steel, with a choice of rotor and stator materials to suit individual applications e.g. hard chrome plated rotor or natural rubber stator.

### High pressure / long haul pumping

Can offer considerable project cost savings by utilizing small bore pipework and eliminating the need for a series of pumps, when pumping over long distances or with high head requirements.

### Low running speeds

Reduced wear for a longer working pump life which extends the periods between routine maintenance. Think of the savings that could be realized on abrasive applications.

### Duracoat coating

Rotors can be supplied with Monoflo's range of specialized coatings to help extend the life of the rotors through improved wear and corrosion resistance.

### Viscous products and Heavy Solids

The pump can be supplied with a square inlet and auger to convey viscous slurries and heavy solids into the pumping element.

### Gentle pumping action

Minimizes shear and crush damage to the pumped product.

### Up to 28ft suction lift

Deep sumps can be easily pumped without the use of submersible equipment.

### Inspection cover

Available for applications where rag content is a problem.

### Robust drives

Specially selected drives and gearboxes for longer life. Options include electric motor drive units supplied as overhead v-belt driven, direct-coupled or variable speed drives with mechanical variable speed or frequency inverter.



One Company, Unlimited Solutions

# Performance Data

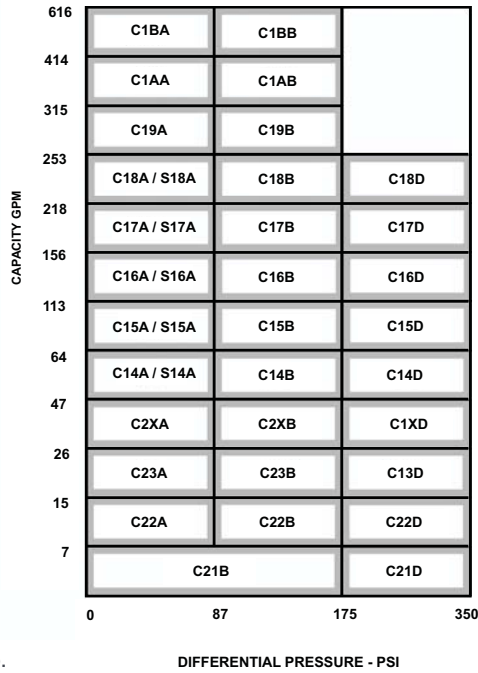
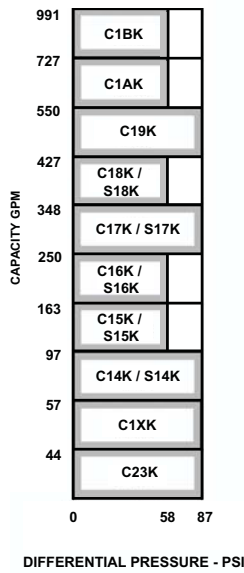

For guidance in selecting a pump, please contact Monoflo.

# Dimensions

MODEL	LENGTH	WIDTH	HEIGHT	F	G
C1XK	51	12	12	2	2
C14K	66	12	19	3	3
C15K	70	14	19	3	3
C16K	77	14	19	4	4
C17K	97	14	24	6	6
C18K	104	17	24	6	6
C19K	114	17	26	8	8
C1AK	120	17	26	8	8
C1BK	137	21	21	10	10
C13D	72	14	19	3	2
C2XA	44	12	12	2	2
C2XB	52	12	12	2	2
C1XD	80	17	19	3	3
C14A	57	12	19	3	3
C14B	66	12	19	3	3
C14D	84	14	19	3	3
C15A	60	12	19	3	3
C15B	72	14	19	3	3
C15D	109	17	24	4	4
C16A	64	14	19	4	4
C16B	92	17	24	4	4
C16D	127	21	19	6	6
C17A	81	14	23	6	6
C17B	97	14	24	6	6
C17D	145	21	29	8	6
C18A	87	14	23	6	6
C18B	110	17	26	6	6
C18D	151	21	21	8	8
C19A	96	17	26	8	8
C19B	114	17	26	8	8
C1AA	99	17	26	8	8
C1AB	126	21	29	8	8
C1BA	112	21	29	10	10

MODEL	LENGTH	WIDTH	HEIGHT	F & G
C21B	39	12	12	1 1/4"
C21D	45	12	12	1 1/4"
C22A	39	12	12	1 1/4"
C22B	45	12	12	1 1/4"
C22D	61	12	12	1 1/2"
C23A	43	12	12	1 1/2"
C23B	49	12	12	1 1/2"
C23K	49	12	12	1 1/2"

## Square Inlet Units

MODEL	LENGTH	WIDTH	HEIGHT	F	G
S14A	57	12	19	7 x 7	3
S14K	66	12	19	7 x 7	3
S15A	60	12	19	7 x 7	3
S15K	70	14	19	7 x 7	3
S16A	65	14	19	8 x 8	4
S16K	77	14	19	8 x 8	4
S17A	81	14	23	9 x 9	6
S17K	97	14	24	9 x 9	6
S18A	87	14	23	9 x 9	6
S18K	104	17	24	9 x 9	6

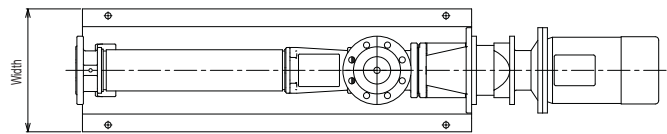
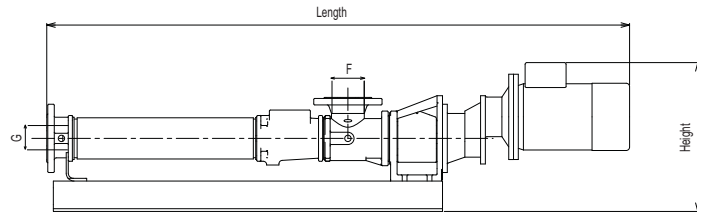

All dimensions in inches and for guidance only. Flanges to ANSI B16.1, B16.5 and NPT pipe thread.

Published information other than that marked CERTIFIED does not extend any warranty or representation, expressed or implied, regarding these products. Any such warranties or other terms and conditions of sales and products shall be in accordance with Monoflo's standard terms and conditions of sale, available on request.

Monoflo products are marketed outside North America under the mark Mono.  
Literature reference: MFI-C/R2 Flyer  
Monoflo® is a registered trademark of Mono Pumps Ltd.



One Company, Unlimited Solutions