

OPERATING LIMITS

Flow rates up to:	2 m ³ /h
Head up to:	11 m
Max. operating pressure:	10 bar
Temperature range:	-10°C to 110°C*
Max. ambient temperature:	+ 40°C

*up to 50% glycol by volume

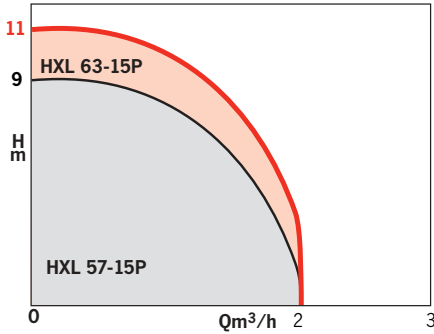

ADVANTAGES

- **QUIET:** curves appropriate for solar-thermic installation, flow limited to reduce flowing-water noise.
- **RELIABLE:** High starting torque.
- **NO SEALING PROBLEM:** direct connection, without adapter rings.

HYDRAULIC PERFORMANCES

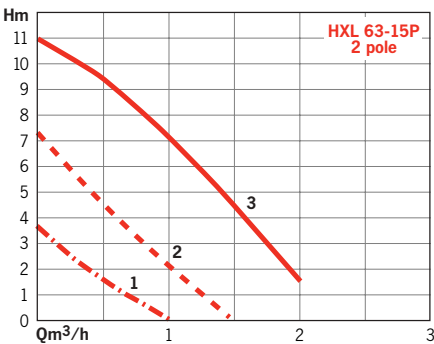
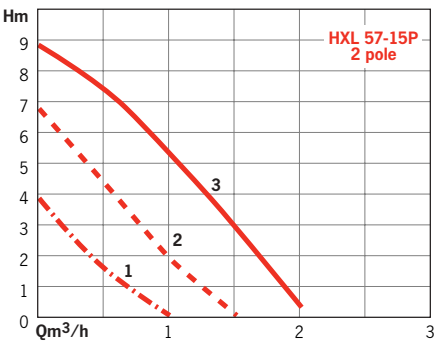

HXL

HIGH PRESSURE CIRCULATORS

Solarthermic - Air-conditioning

50 Hz

APPLICATIONS

Accelerated hot - or cold - water circulation in open or closed circuits:

- Solarthermic installation
- Air conditioning
- New installations

- Old installations (renovations)
- Extensions.



• HXL 57-15P DIMENSIONS • HXL 63-15P

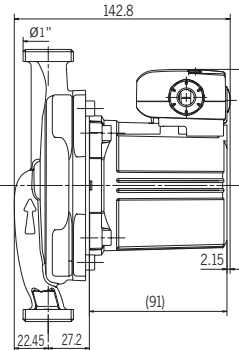
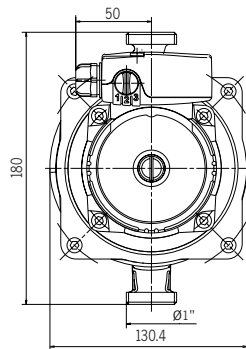
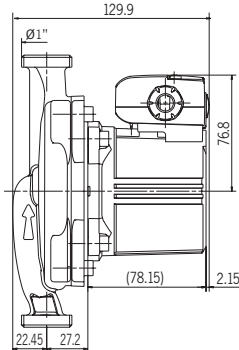
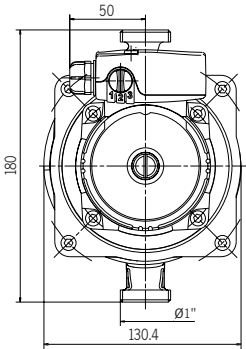

FITTING POSITIONS

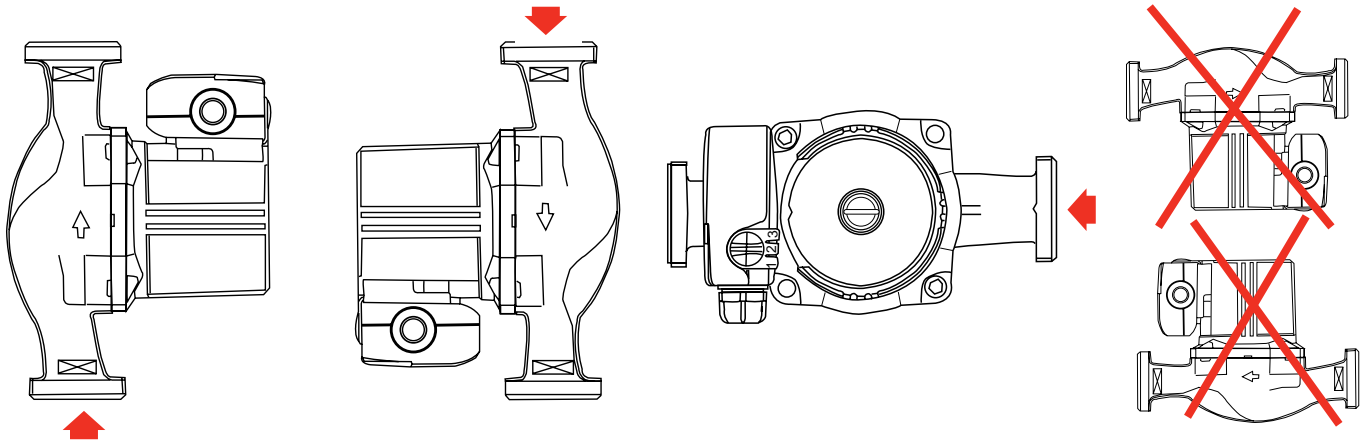

ELECTRICAL DATA

ORDER REFERENCE	M O T O R				P U M P			CAN BE CONNECTED TO THREADED PIPE Ø 3/4"
	P2	capacitor	selected speed	speed	P1	Current	mass	
	W	µF x V		(rpm)	(W)	(A)	(kg)	
HXL 57-15 P	47	3	1	800	50	0.25	2.6	
			2	1150	78	0.35		
			3	1700	110	0.50		
HXL 63-15 P	50	3.5	1	700	75	0.35	2.95	
			2	1000	115	0.55		
			3	1600	165	0.72		

FEATURES

a) Electrical

- All types single-phase, 230-V, 50-Hz, with capacitor built into terminal box.
- Motor protection circuit-breaker not required.

b) Installation

- Motor shaft always horizontal.
- Connection to installation by unions.

c) Packaging

- Supplied with gaskets, without unions.

d) Maintenance

- Standard exchange of circulator.

OPTIONS AND ACCESSORIES

- Unions
- Isolating valves.
- Unsticking plug; facilitates unsticking of shaft and rotor (without removing plug).

STANDARD CONSTRUCTION

Main part	Material
Pump housing	Cataphorese
Impeller	Composite material
Shaft	Stainless steel
Impeller neck ring	Stainless steel
Bearings	Graphite
Seals	Ethylene-Propylene
Motor housing	Aluminium

MINIMUM SUCTION PRESSURES ACCORDING TO OPERATING TEMPERATURE

Type	50°C	95°C	110°C
All models	0.5 m w.g.	3 m w.g.	10 m w.g.
	10.2 m w.g. = 1 bar		

To avoid bearing damage and the risks of cavitation of the pump, it is essential to observe the minimum pressures stated above.

DESIGN

• Pump

Pump casing with threaded ports for direct mounting on pipe.
Rotating parts in contact with water made of corrosion-proof materials.
Stainless-steel impeller wear ring.

• Motors

Three speeds with manual selection.
Wet rotor, bearings lubricated by pumped liquid.
Manual bleed when started up.

Speed	: see table
Winding	1-phase : 230 V
Frequency	: 50 Hz
Insulating category	: F (155°C)
Temperature class	: TF110
Protection index	: IP 42
Conformity	: EN 61000-6-3 EN 61000-6-2 : EC
Type approvals	: VDE - IMQ