

## OPERATING LIMITS

Flow up to:	0,45 m <sup>3</sup> /h
Maximum operating pressure:	10 bar
Minimum suction pressure:	0,2 bar*
Temperature range:	0° à + 95°C
Maximum ambient temperature:	+ 40°C
Water hardness (TH):	35°F
DN of ports:	ø 15

\* at + 65° C

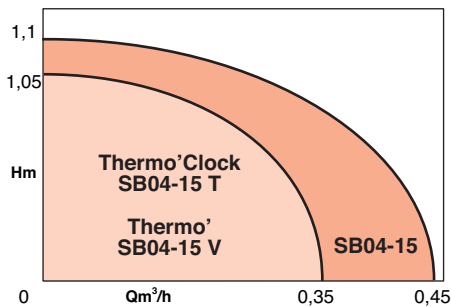

## ADVANTAGES OF THE RANGE

- Takes up little space
- The Thermo and Thermo'clock versions include valve and stop-tap in just 138 mm between centres.
- Ultra Silent
- Specially-designed mechanics.
- Reliable
- New design to avoid the build-up of scale
- Rapid electrical connexions
- Wide opening for the electric cables
- Three widely-spaced levers
- Very legible "Earth – Live – Neutral" markings
- Ports easily accessible, for cables up to 2.5 mm<sup>2</sup>
- Easy to clean
- Easily dismantled for any repairs to the components in contact with water

# THERMO RANGE

## SIMPLE DOMESTIC CIRCULATING PUMPS

Domestic hot water  
50 Hz

## APPLICATIONS

Faster circulation in domestic hot water distribution systems.

- Industrial systems.
- Solar circuits.
- Domestic installations.

**Obtain instant hot water at the turn of a tap ; no stagnant water in the domestic hot water system.**

Particularly suitable for boilers on the ground floor.



# THERMO RANGE

## THE THERMO'CLOCK EXTRAS

### Extra comfort

-The precision of the thermostat guarantees hot water at the temperature you want as soon as you turn the tap.

### Extra safety

-Supports boilers in the fight against Legionnaires Disease

Boilers are increasingly incorporating automatic heat disinfection to kill Legionella.

This operation involves raising the temperature of the water in the cistern to approx. 70°C.

The "Thermal Disinfection" function of the Thermo'clock detects this operation and starts up to facilitate the circulation of water in the pipes.

- Automatic descaling

### Extra economy

#### Energy:

-Reduced running time

-The Programmer provides an operation that suits the needs of users

#### Water:

-Less water wasted

-Instant distribution of hot water

#### Time:

- No more time lost waiting for hot water.

## ADJUSTMENT



### • The Icons

#### Time menu

Set the present time



#### Programmer Menu

Possible to program up to three time-slots (on/off) in any 24-hour period



#### Thermostat Menu

- Adjust the temperature settings

-Option of switching the "Thermal Disinfection" function on or off.



#### Display Menu

-Displays the present time or alternatively the minimum temperature set.

-If the message "Thermal Disinfection" is displayed, this function is activated

### • Simple and intuitive adjustments

Turn to select an icon or set a parameter



Pressure > 3 sec:

Selects a menu

Short pressure:

Confirms the setting of a parameter

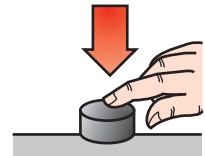

## DESIGN

### • Motor

Speed:	2600 tr/mn
Single winding:	230 V
Frequency:	50 Hz
Class of insulation:	155 (F)
Conformity:	NF EN 60.335.2.51 CE

## BASIC CONSTRUCTION

Main parts	Material
Body of pump	Brass
Body of motor	Polypropylene
Impeller	Composite material
Rotor shaft	Stainless steel
Bushes	Graphite
Rotor sleeve	Stainless steel
Pump joint	Ethylene Propylene

## HYDRAULIC PERFORMANCE

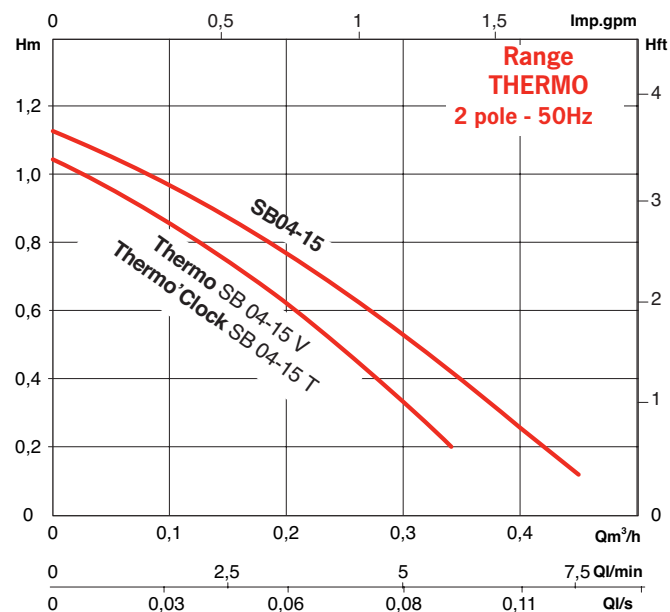

# THERMO RANGE

## INSTALLATION PLAN AND DETERMINING THE PUMP

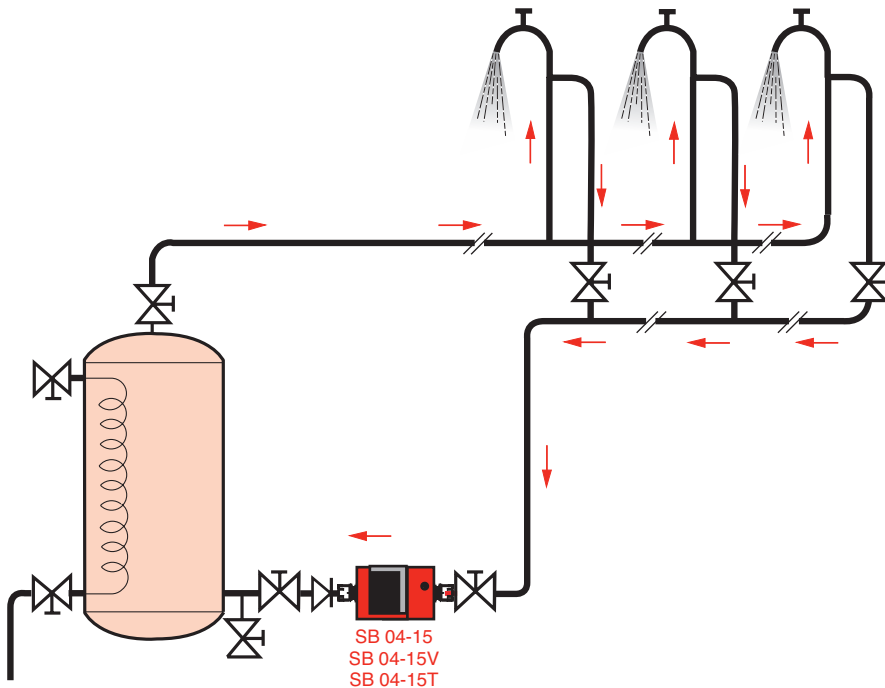

Domestic hot water distribution loop

- Maximum temperature of the loop 60°C (D.T.U standard).
- Maximum recommended speed of flow between 0.5 and 1 m/s.
- Circulating pump mounted on the return leg of the loop, after the taps.

Overall length Piping	accommodates 1 to 10 tapping points
0 to 35 m	SB04-15 Thermo SB04-15 V Thermo'Clock SB04-15 T NSB05-15B
36 to 75 m	NSB10-15B
76 to 100 m	NSB15-15B

Selection for information purposes only, with the following criteria:

- Insulation Class 2 for the pipe-runs
- Hot water temperature: 60°C
- Fall of temperature round the system: 3°C
- Ambient temperature: 20°C
- External temperature: -7°C
- Ø of pipework: 15 mm

## EXPLODED VIEW

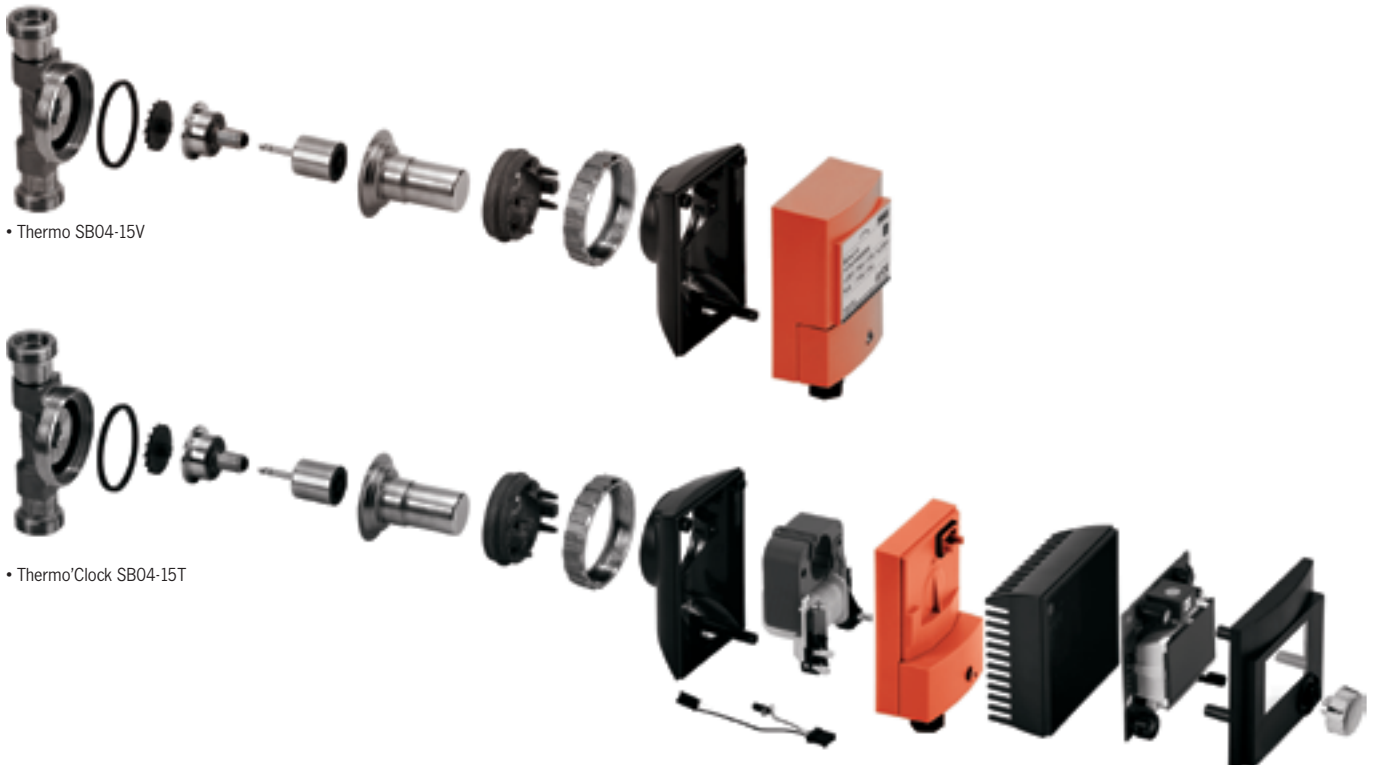

• Thermo SB04-15V

• Thermo'Clock SB04-15T

# THERMO RANGE

## POSITIONS FOR FITTING

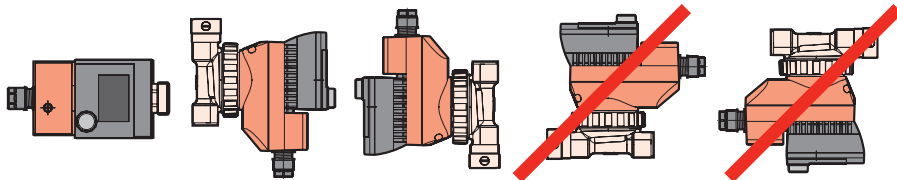

## FEATURES

### a) Electrical

All types in single-phase 230 V - 50 Hz  
Standard voltage:  
- tolerance 50 Hz  $\pm$  10 %,  
- tolerance 60 Hz  $\pm$  6 %,

### b) Fitting

- Fitted directly onto horizontal or vertical pipework, on the return leg of the distribution loop, after the taps.  
- Axle of motor always horizontal.  
Connection to the installation:  
Depending on the model:  
- with copper pipes, use soldered copper (R) connectors or screw-on brass (RU brass) connectors,  
- with galvanised steel pipes use screw-on steel (RU) connectors.

### c) Pack contains

- Supplied with joints, without connectors.

### d) Maintenance

- Exchange standard of the appliance.

## ELECTRICAL CHARACTERISTICS AND SIZES

• Thermo'Clock SB 04-15T

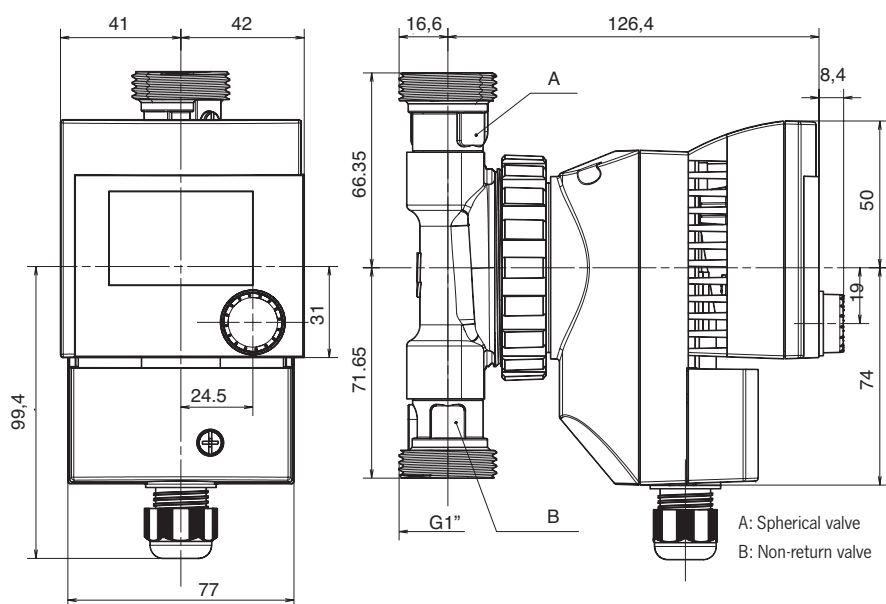

• Thermo SB 04-15V

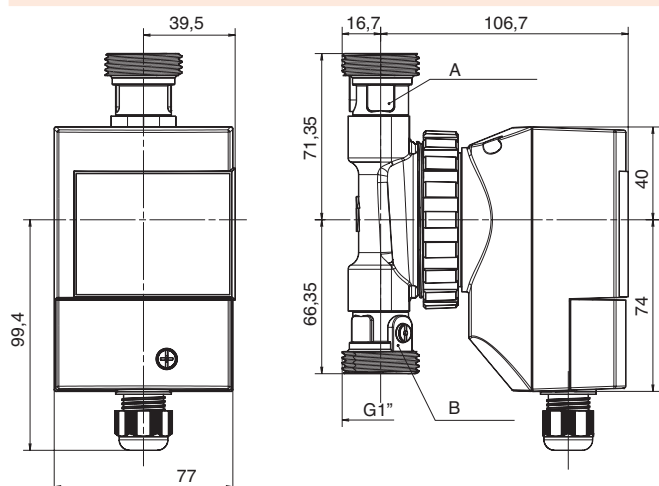

• SB 04-15

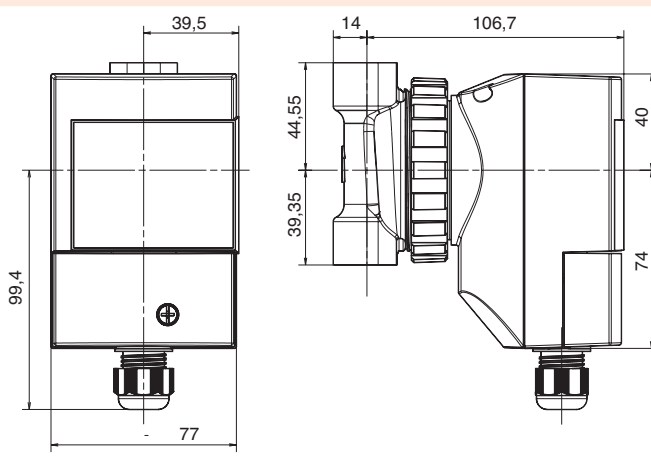

## RECOMMENDED ACCESSORIES

- Soldered connectors
- Brass or steel union connectors
- Stop-cocks

### REFERENCE FOR ORDER

	MOTOR			PUMP	Connect to	
	Speed r.p.m.	P1 rating W	Amperage A		Soldered pipes	Threaded pipes
SB 04 - 15	2600	22	0,25	1,7	-	-
Thermo SB 04 - 15 V	2600	22	0,25	1,9	G1	RU 2022 (brass) RU 1521 (brass)
Thermo'clock SB 04 - 15 T	2600	22	0,25	2,1	G1	RU 2022 (brass) RU 1521 (brass)