

## OPERATING RANGES

Flow rates up to:	16 m <sup>3</sup> /h
Pressure heads up to:	87 m
Max water temperature:	+ 40°C
Max sand content:	50 g/m <sup>3</sup>
Discharge orifice ND:	1"1/4

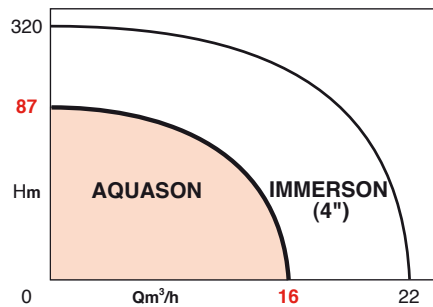

## ADVANTAGES

- Exceptional lifetime owing to the robustness of the materials used.
- Insulated motor.
- Submersible up to 15m.
- Vertical or horizontal motor installation.
- Limited risk of frost.
- Noise-free operating.
- Plug-in motor power cable for easy maintenance.

### AL (lateral suction) version

- The suction floating filter guarantees a clearer water without any particles.

# AQUASON

## DOMESTIC WELL 5" STAINLESS STEEL PUMPS

Water supply - Irrigation - Boosting  
2 pole - 50Hz

## APPLICATIONS

Pumping and distribution of clear, pure water

for various domestic uses:

- Domestic water supply
- Small-scale irrigation
- Supplying of water fountains
- Pressure boosting

- Rainwater collection

Collecting from a shallow well, a tank, a cistern, etc.

Not for use draining swimming pools, ornamental pools, etc.

• AQUASON AL pump

• AQUASON pump



• AQUASON AL PAP pump

# AQUASON

## DESIGN

### • Hydraulic part

#### - Monobloc, longshaft pump

- Stainless steel multistage pump with 3 to 8 radial impellers and stages.
- Vertical discharge.
- Suction strainer in the lower part to prevent particles from entering the hydraulic part.

### • Motor

- Asynchronous.
- Double mechanical seal.
- Stator isolated by a stainless steel sleeve.
- 20m long HO7RNF type electrical cable, plugged in via motor connector.
- Single phase motor thermal protection and automatic reset (PTO). Supplied with a control panel integrating: on/off functions switch, reset button, connection terminal for dry running protection and capacitor.

Speed:	2900 rev/min
Winding: 1-phase:	230V
3-phase:	400V
Frequency:	50Hz
Isolation class:	155 (F)
Protection index:	IP 68
Start-ups/hour:	40 max
CE compliance	

## STANDARD CONSTRUCTION

Main parts	Materials
Suction strainer body	AISI 304 SS
Impeller/Stages/Diffusers	AISI 304 SS
Shaft	AISI 304 SS
Bearing support	Aluminium
Corps de refoulement	Nickelled brass
Outer sleeve	AISI 304 SS
Mechanical seal	Silicon carbide/Silicon carbide Carbon/Ceramic

## SECTIONAL DRAWING

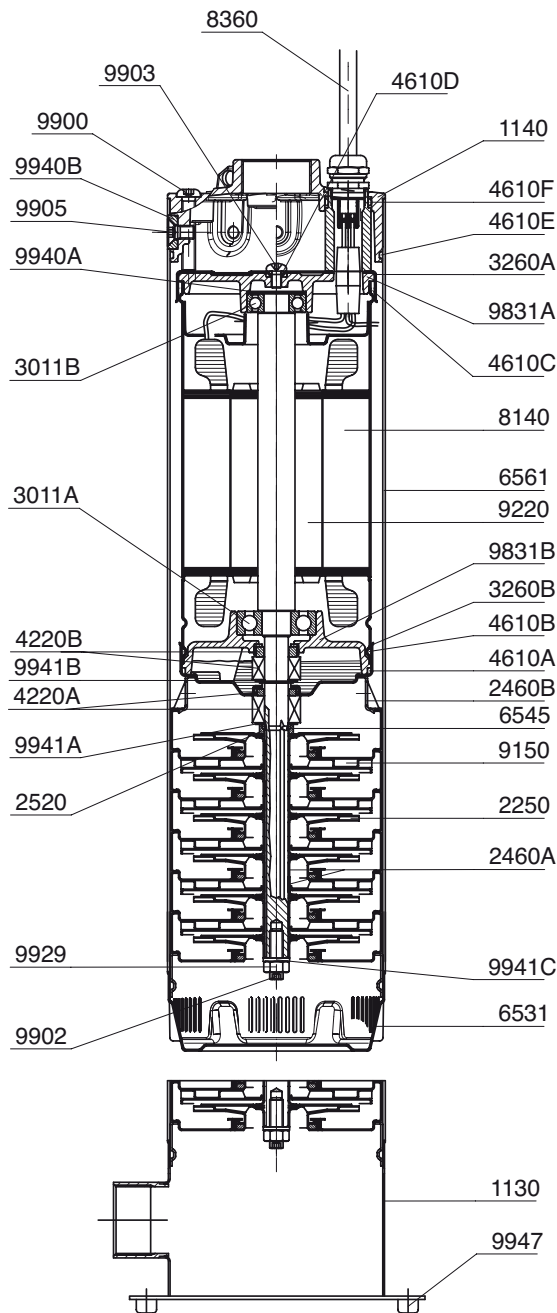

### N° Part name

1130	Suction casing
1140	Delivery casing
2250	Impeller
2460A	Impeller spacers
2460B	Spacer
2520	Thrust ring impeller/rush
3011A	Bottom bearing
3011B	Top bearing
3260A	Upper motor cover
3260B	Lower motor cover
4220A	Mechanical seal
4220B	Mechanical seal
4610A	O-ring
4610B	O-ring
4610C	O-ring
4610D	O-ring
4610E	O-ring
4610F	O-ring
6531	Suction strainer
6545	1/2 Stop rush (impeller/mechanical seal)
6561	External housing sleeve
8140	Stator
8360	Electrical cable
9150	Stage casing with diffuser
9220	Shaft rotor
9831A	Top bearing
9831B	Bottom bearing
9900	Special screw
9902	Hexagonal socket heat cap screw
9903	Recessed cheese head screw
9905	Hexagonal socket countersunk heat cap screw
9929	Impeller nut
9940A	Spring washer
9940B	Special washer
9941A	Thrust ring
9941B	Thrust ring
9941C	Washer under nut
9947	Damping washer

## IDENTIFICATION

<b>AQUASON - 304 - M - AL - / B</b>	
Pump family	304
nominal flowrate in m <sup>3</sup> /h	M
Number of stages	AL
M - single-phase 230V	
T4 - Tree-phase 400V	
AL - Lateral suction	
B - Indice of technical evolution	B

## HYDRAULIC PERFORMANCES AT 2900 RPM

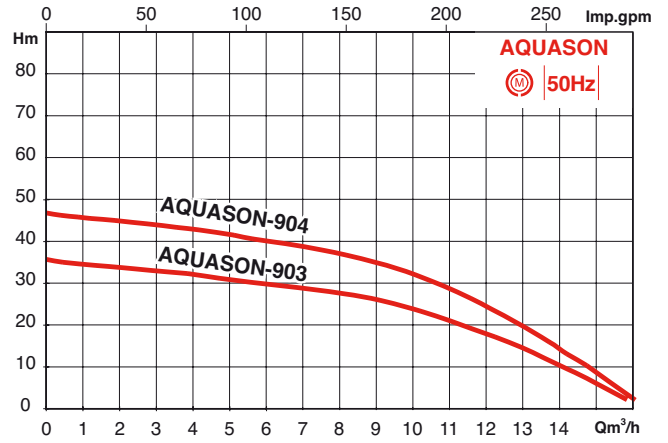
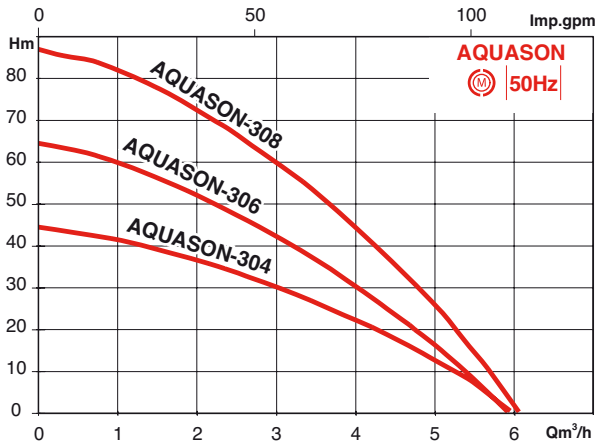

## INSTALLATION DIAGRAMS

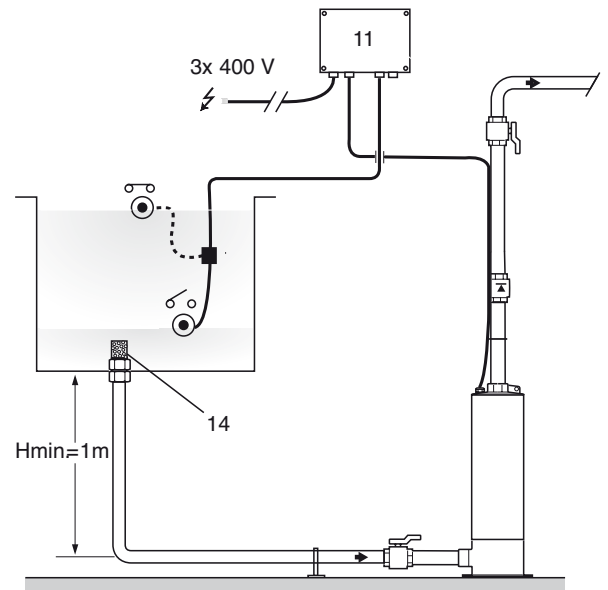
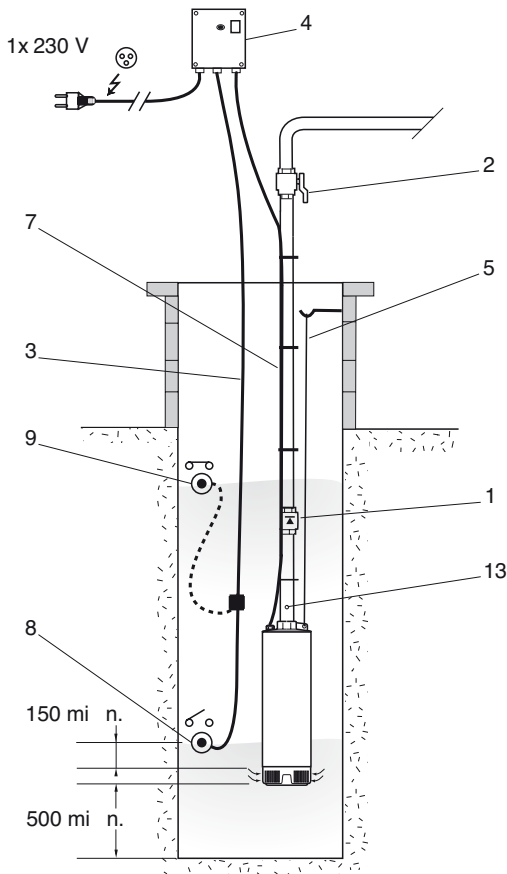

- 1 - Non return valve
- 2 - Valve
- 3 - Float switch
- 4 - Connection box (single-phase)
- 5 - Carrying rope
- 7 - Supply cable
- 8 - Float in low position
- 9 - Float in high position
- 11 - Connection box (three-phase)
- 12 - Floating tapping device
- 13 - Draining air hole to realize
- 14 - Suction strainer

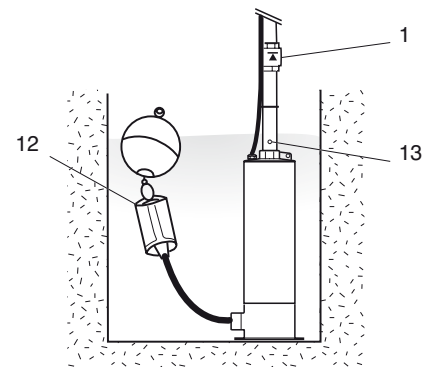

# AQUASON

## ELECTRICAL DATA AND DIMENSIONS

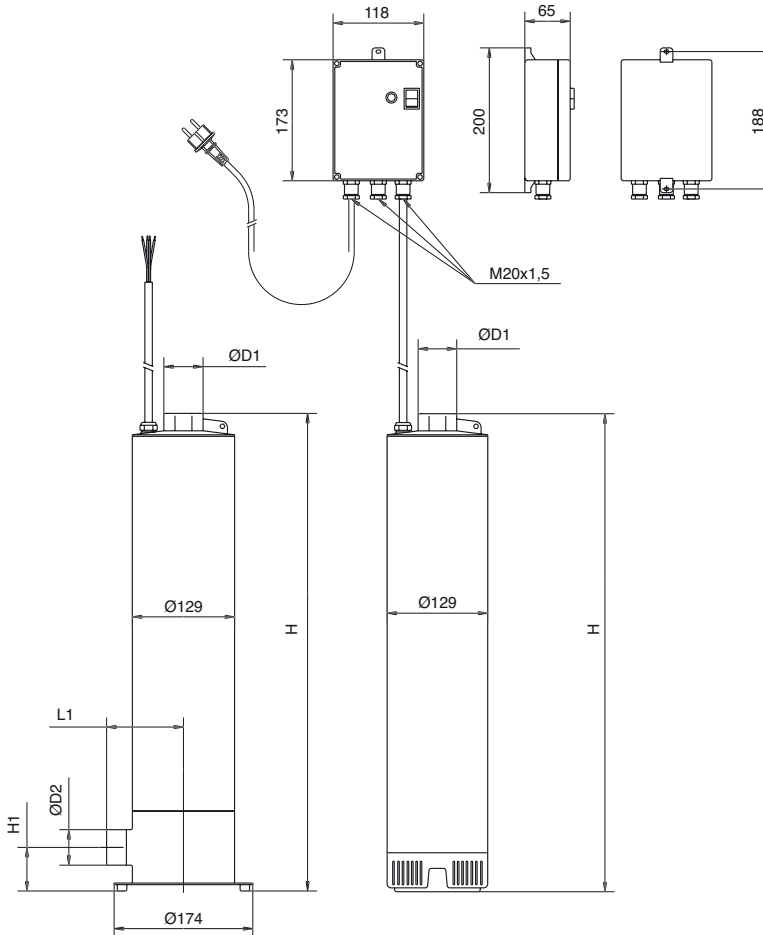

TYPE	P2 Kw	P1 Kw	Power supply V	Current A	Condensator $\mu\text{F/V}$	D1	D2	H	H1	L1	Weight (Without packing) Kg	Number of stages
AQUASON-304-M	0,55	0,85	1x230	4,5	20/450	1"1/4		480			16,5	4
AQUASON-306-M	0,75	1,2	1x230	5,6	20/450	1"1/4		528			17,5	6
AQUASON-308-M	1,1	1,55	1x230	7,4	30/450	1"1/4		576			21	8
AQUASON-903-M	1,1	1,4	1x230	7,2	30/450	1"1/4		504			19	3
AQUASON-904-M	1,5	1,9	1x230	10,1	35/450	1"1/4		584			21,5	4
AQUASON-306-T4	0,75	1,2	3x400	2,3		1"1/4		528			17,5	6
AQUASON-308-T4	1,1	1,55	3x400	2,7		1"1/4		576			18,5	8
AQUASON-903-T4	1,1	1,4	3x400	2,5		1"1/4		504			17	3
AQUASON-904-T4	1,5	1,9	3x400	3,2		1"1/4		584			19,5	4
AQUASON-304-M-AL	0,55	0,85	1x230	4,5	20/450	1"1/4	1"1/4	539	55	93,5	17	4
AQUASON-306-M-AL	0,75	1,2	1x230	5,6	20/450	1"1/4	1"1/4	587	55	93,5	18	6
AQUASON-308-M-AL	1,1	1,55	1x230	7,4	30/450	1"1/4	1"1/4	635	55	93,5	21,5	8
AQUASON-903-M-AL	1,1	1,4	1x230	7,2	30/450	1"1/4	1"1/4	563	55	93,5	19,5	3
AQUASON-904-M-AL	1,5	1,9	1x230	10,1	35/450	1"1/4	1"1/4	643	55	93,5	22	4
AQUASON-306-T4-AL	0,75	1,2	3x400	2,3		1"1/4	1"1/4	587	55	93,5	18	6
AQUASON-308-T4-AL	1,1	1,55	3x400	2,7		1"1/4	1"1/4	635	55	93,5	19	8
AQUASON-903-T4-AL	1,1	1,4	3x400	2,5		1"1/4	1"1/4	563	55	93,5	17,5	3
AQUASON-904-T4-AL	1,5	1,9	3x400	3,2		1"1/4	1"1/4	643	55	93,5	20	4

## FEATURES

### a) Electrical

- "M" types: 230V – 50Hz 1-phase with start-up unit, capacitor and heat protection.
- "T4" types: 400V – 50Hz 3-phase. Motor with thermal protection.

### b) Assembly

- In a vertical position.
- Connection to the system:
  - via  $\text{Ø}1^{1/4}$  hard or soft pipe.
  - Lowering of the pump into the well via the nylon rope, using the anchor ring secured to the pump.

### c) Packaging

Delivered packaged in a cardboard box with 20m of cable connected to the pump, 20 m of nylon rope and pump anchor ring for lowering into the well. Single-phase model with start-up and protection unit, capacitor and standardised plug (pump and unit connected in the factory).

### d) Maintenance

Standard replacing of the device or repairing of the hydraulic part and the motor.

## ACCESSORIES

- ACSO
- Check valve
- 3-phase motor protection contact breaker
- Single bladder tank
- Pressure gauge
- Isolating valves
- Float switch (Reference: 20m FLOAT SWITCH 4020853 kit)
- ALARMSO overflow audible alarm
- PMS (motor protection and level monitoring via electrode) unit.
- **AL (lateral suction) version:**
  - Large mesh float suction filter.
  - Small mesh float suction filter.
- **Floating filter:**
  - F Filter: 0.23mm small mesh floating filter.
  - FR Filter: 0.23mm small mesh floating filter with built-in check valve.
  - G Filter: 1mm large mesh floating filter.
  - GR Filter: 1mm large mesh floating filter with built-in check valve.

## PAP

The PAP package offers:

- An Aquason AL pump
- An Acson automatic unit
- A floating F filter
- Two unions
- A 1.5m hose
- All the electrical elements are prewired.