

OPERATING LIMITS

Flow up to:	140 m ³ /h
Head up to:	46 m
Temperature range:	+ 5° to 80°C
Max. operating pressure:	6 bar
DN of ports:	40 to 100

TP 2800

SELF-PRIMING CENTRIFUGAL PUMPS Dewatering - Draining 50 Hz

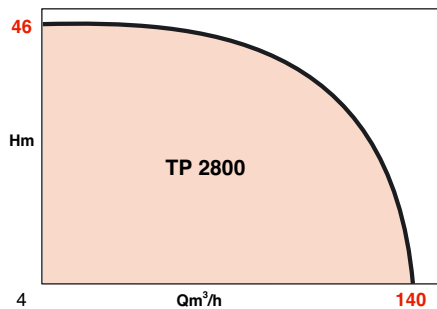

APPLICATIONS

- Dewatering of excavation sites, public works sites.
- Drainage of flooded basements, garages.
- Sprinkling, irrigation.
- Dewatering of seepage water... And for all pumping of clear, dirty or slightly particulate-laden water.

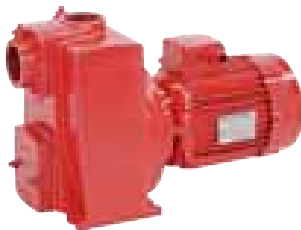

• TP 2800, monobloc with electric motor

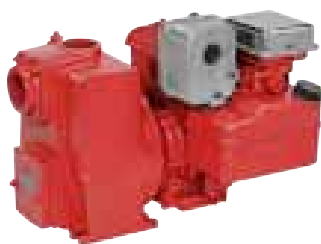

• TP 2800, monobloc with internal combustion engine

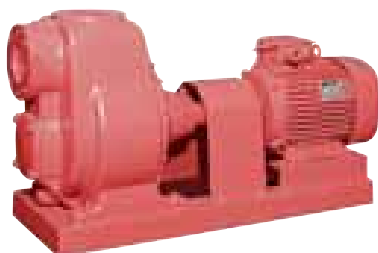

• TP 2800, complete assembly on baseplate



• TP 2800, monobloc with internal combustion engine, on trolley, the advantage of self-contained operation

TP 2800

ADVANTAGES

- Automatic self-priming.
- Suction lift without fouling up to 7.50 m max.
- Easy maintenance: inspection door provided for quick cleaning of the impeller inlet (except TP 2802).
- Easily interchangeable impeller, diffuser and wear plate.

DESIGN

• Pump

Centrifugal, self-priming.
Casing with priming vessel and inspection door facilitating cleaning of the impeller inlet (except TP 2802).
Filling plug.
Highly resistant, open impeller.
Mounting feet under pump casing.
Suction check valve (except TP 2802)

• Electric motor

Speed: 1450 & 2900 rpm
Winding: 3-ph. : 230 - 400 V
Frequency: 50 Hz (optional 60 Hz)
Insulation class: F
Protection: IP 55
EC conformity: EN 809809

• Internal combustion engine

4 stroke
Speed (no load): 3600 rpm
Cooling: air
Carburetor: pulsating jet type
Choke: manually actuated
Starter: cord actuated

STANDARD CONSTRUCTION

Main parts	Material
Casing	TP 2802 Aluminium
	other types Cast iron (FGL 250)
Open impeller	Cast iron (FGL 250)*
Diffuser	Cast iron (FGL 250)
Pump shaft	Steel (Z30 C13)
Mechanical seal	TP 2802-2805 Carbon/Alumina/Nitrile
	Other types Carbide/Carbide/Nitrile

* with Molybdene

SECTIONAL VIEW

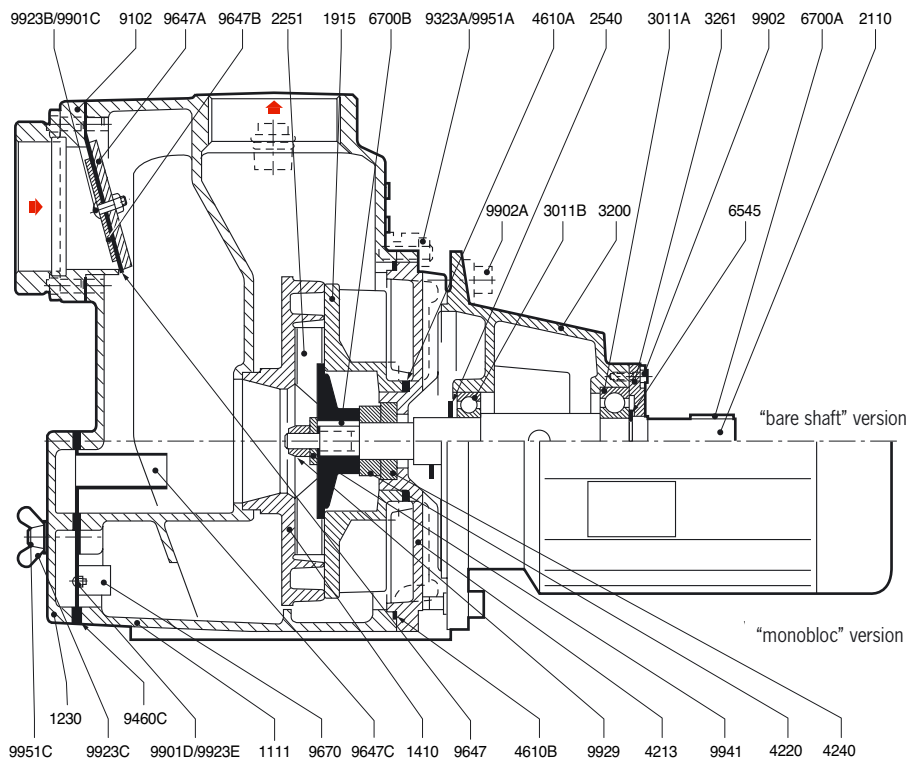

PARTS LIST

- 1111 - Pump casing
- 1230 - Inspection door
- 1410 - Diffuser
- 1915 - Wear plate
- 2110 - Pump shaft (bare-shaft version)
- 2251 - Open impeller
- 2540 - Deflector
- 3011A - Bearing (bare shaft version)
- 3011B - Bearing (bare shaft version)
- 3127A - Adjustment washer
- 3127B - Adjustment washer
- 3200 - Bearing
- 3261 - Bearing cover (bare shaft version)
- 4213 - Insert holder plate
- 4220 - Rotary ring | Mechanical seal
- 4240 - Fixed ring | seal
- 4610A - O-ring (wear plate/end casing)
- 4610B - O-ring (casing/end casing)
- 6545 - Circlip (bare shaft version)
- 6700A - Coupling key (bare shaft)
- 6700B - Impeller key
- 8020 - Electric motor
- 9102 - Suction tube
- 9460C - Inspection door gasket
- 9621 - Filling plug
- 9647 - Suction check valve
- 9647A - Check valve top load
- 9647B - Check valve bottom load
- 9647C - Plate + ejector
- 9670 - Ejector spring
- 9902 - Bearing cover attachment screw (bare shaft)
- 9901C - Check valve loads attachment screw
- 9901D - Ejector spring attachment screw
- 9902A - Bearing attachment screw (bare shaft)
- 9906 - Electric motor (or bearing) attachment screw
- 9923A - Nut (plate/casing)
- 9923B - Nut (check valve loads)
- 9923C - Wing nut (inspection door)
- 9932E - Nut (ejector spring)
- 9929 - Impeller locking nut
- 9941 - Washer under impeller nut
- 9951A - End casing/casing attachment stud
- 9951C - Inspection door attachment stud

(•) Recommended spare parts

AVAILABLE VERSIONS

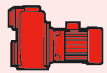

MONOBLOCK

TP 2802-T
TP 2810-T
TP 2820-T

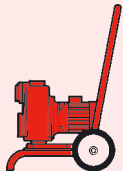

MONOBLOCK ON TROLLEY

TP 2802-T-R
TP 2810-T-R
TP 2820-T-R

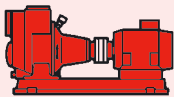

COMPLETE UNIT ON BASE PLATE

TP 2820-T-S
TP 2840-T-S
TP 2845-T-S

ON REQUEST

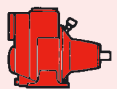

BARE SHAFT WITH BEARING

TP 2802 TP 2840
TP 2810 TP 2845
TP 2820

HYDRAULIC PERFORMANCES WITH ELECTRIC MOTOR

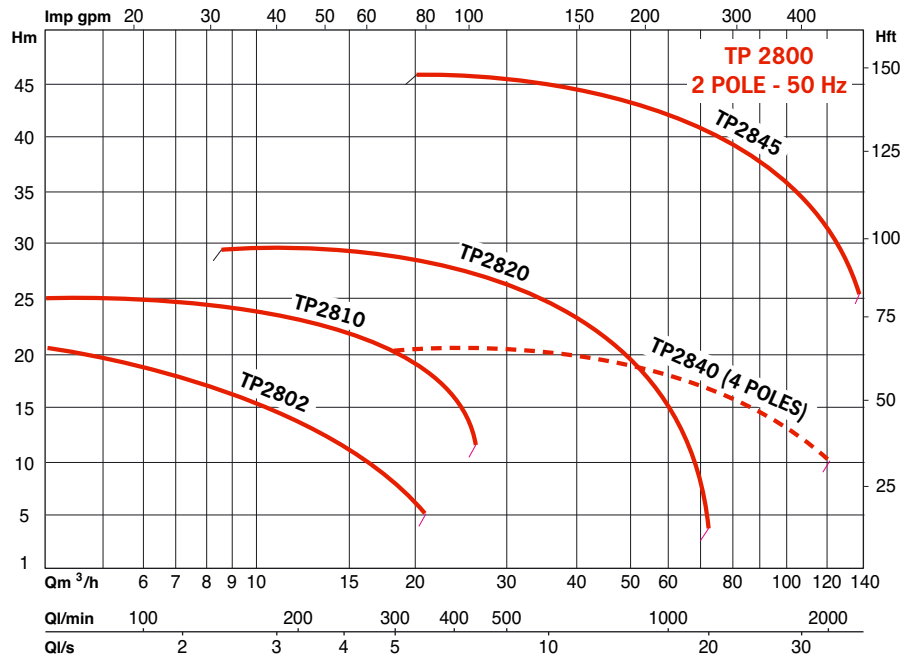

HYDRAULIC PERFORMANCES WITH INTERNAL COMBUSTION ENGINE

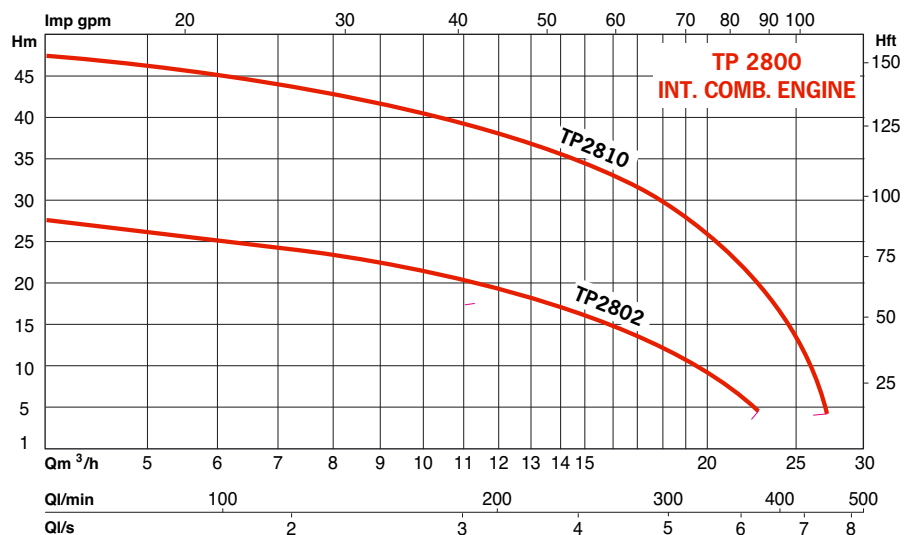

MONOBLOCK

TP 2802-E
TP 2810-E



MONOBLOCK ON TROLLEY

TP 2802-E-R
TP 2810-E-R

CONTACT US:

For DIESEL engine, models:
complete unit on baseplate

TP 2820 } complete
TP 2840 } unit on
TP 2845 } base plate

IDENTIFICATION

Pump code (TP2800) ——— **MOTOR**
 TP28 02-T-R ——— Electrical 3 ph. 230-400 V
 T-R ——— Electrical 3 ph. 230-400 V on trolley
 T-S ——— Electrical 3 ph. 230-400 V on base plate
 E-R ——— GASOLINE
 Pump size ——— E-R ——— GASOLINE on trolley

TP 2800

ELECTRICAL DATA AND DIMENSIONS

WITH ELECTRICAL MOTOR

• MONOBLOC "T" VERSION

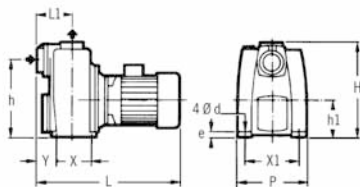

• BASE PLATE "T-S" VERSION

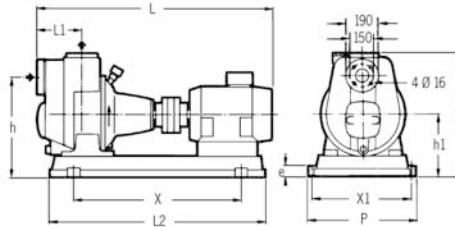

ORDER REFERENCE	motor P2 kW	full-load current 230V 400V	ports DN	H mm	L mm	P mm	h mm	L1 mm	X mm	X1 mm	Y mm	L2 mm	Ød mm	e mm	weights solids size* kg mm		
TP 2802-T	0.11	04.5	02.6	1 1/2" M	293	399	184	238	087	122	140	31	-	10	10	019	06
TP 2810-T	0.22	07.7	04.4	2" F	311	484	229	249	118	129	180	64	-	10	14	043	06
TP 2820-T	0.42	14.2	08.2	3" F	363	600	260	288	174	190	210	94	-	14	19	075	12
TP 2820-T-S	0.42	14.2	08.2	3" F	446	910	360	371	174	540	320	-	0840	10	43	100	12
TP 2840-T-S	0.75	26.3	15.2	100	591	950	450	477	187	660	400	-	1040	12	53	170	20
TP 2845-T-S	1.85	57.5	33.2	100	591	1590	450	477	187	660	400	-	1040	12	53	285	18

* Solids size at impeller passage.

INTERNAL COMBUSTION ENGINE ON TROLLEY VERSION

NOTE:

Same dimensions as for the monobloc version with electrical motor on trolley.

Order ref.: **TP 2802-T-R**
TP 2810-T-R

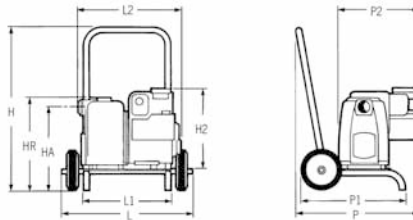

ORDER REFERENCE	model	int. comb. engine		ports DN	H mm	L mm	P mm	HA mm	HR mm	L1 mm	P1 mm	weight kg	monoblock pump version				
		cyl.	reser										oil	H2 mm	L2 mm	P2 mm	weight kg
		mono bloc	on trolley										voir cap CV	cm ³	L carter	mm	
TP 2802-E	•	3	127	2,8	0,6	1 1/2" M	-	-	-	-	-	-	335	410	350	25	
TP 2802-E-R	•	3	127	2,8	0,6	1 1/2" M	695	580	530	355	400	370	470	32	-	-	-
TP 2810-E	•	5	205	2,8	0,6	2" F	-	-	-	-	-	-	380	485	370	43	
TP 2810-E-R	•	5	205	2,8	0,6	2" F	780	620	580	375	465	410	500	52	-	-	-

QUICK RELEASE SYMETRICAL COUPLINGS

Fire hose: Threaded female - Splined male - with lock

ORDER REFERENCE	Item reference	Pump
P*DN40 TAR G1 1/2 - CAN.REDØ40	4045031	TP2802
P*DN50 TAR G2 - CAN.REDØ50	4045032	TP2810
P*DN40 TAR G3 - CAN.Ø90	4045464	TP2802

Other couplings

ORDER REFERENCE	Item reference	Pump
P*DN32 CAN./CAN.Ø35	4045064	PIPE/PIPE
P*DN40 CAN.RED./CAN.REDØ40	4045025	PIPE/PIPE
P*DN50 CAN.RED./CAN.REDØ50	4045026	PIPE/PIPE
P*DN65 CAN./CAN.Ø70	4045027	PIPE/PIPE
P*DN80 CAN./CAN.Ø90	4045028	PIPE/PIPE
P*DN100 CAN./CAN.Ø110	4045029	PIPE/PIPE

Fire hose: Tapped male - Splined male - with lock

ORDER REFERENCE	Item reference	Pump
P*DN50 FIL. G2 - CAN.REDØ50	4027321	TP2810
P*DN80 FIL. G3 - CAN.Ø90	4044981	TP2820
P*DN100 FIL. G4 - CAN.Ø110	4045023	TP2840
P*DN100 FIL. G4 - CAN.Ø110	4045023	TP2845

Other couplings

ORDER REFERENCE	Item reference
P*DN32 FIL. G1 1/4 - CAN.Ø35	4045062
P*DN40 FIL. G1 1/2 - CAN.REDØ40	4027322
P*DN65 FIL. G2 1/2 - CAN.Ø70	4013186

FEATURES

a) Electrical data

- All types: 3-phase 230-400 V - 50 Hz (T)
- Motor must be protected by circuit-breaker
- Connection to terminal box via stuffing box.

b) Installation

- On foundation, horizontal motor shaft.
- Mounting through pump casing support lugs for monobloc pumps and on baseplate for the other types.

Connection to installation:

- Quick release, symmetrical couplings (optional).

c) Packaging

Supplied without coupling accessories.

d) Maintenance

- Pump and motor, repair and replacement of recommended spare parts (•) subject to wear

OPTIONS AND ACCESSORIES

- Diesel engine.
- Suction and discharge connection accessories.
- Suction strainer.
- Motor protection circuit-breaker.
- Check valve.
- Isolating valves.
- PVC pipe or textile-reinforced hose...

Connecting accessories:

DISCHARGE ELBOW (90°)



ORDER REFERENCE	Item reference
ELBOW G1 1/2" - MF1	055369
ELBOW G2" - MF1	060185
ELBOW G3" - MF1	061592

SPLINED SOCKET

for hose to be installed on the elbow



ORDER REFERENCE	Item reference
SOCKET FC1 1/2"	018820
SOCKET MC2"	018821
SOCKET MC3"	018822

SUCT./DISCH. REF DN100 for TP 2840 - TP 2845)



ORDER REFERENCE	Item reference
CBTP 102/114	73323100101