

## OPERATING LIMITS

Flows rates up to:	12 m <sup>3</sup> /h
Heads up to:	10 m
Temperature range:	from 3° to 35°C
Max operating pressure:	2.5 bar
ND of orifices:	G1"1/2

## TP Mini

# SELF-PRIMING CENTRIFUGAL PUMPS

## Dewatering - Draining 50 Hz

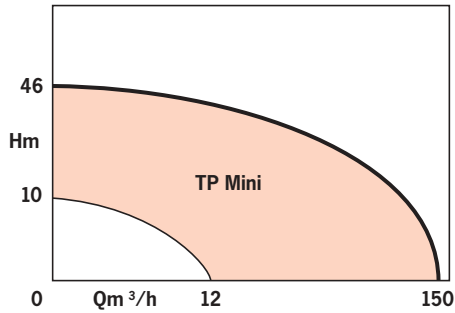

## APPLICATIONS

- Draining of flooded cellars and car parks
- Lifting of well water
- Mobile lifting installation
- Watering and irrigation
- Seawater
- Swimming pools.



• TP Mini - ref.:2048283

# TP Mini

## ADVANTAGES

- Ready-to-install product
- Stainless: composite material body and brass impeller
- Easy to carry thanks to its weight (12kg) and its handle
- Reliable motor thanks to its thermal protection
- Max. particle size: 6mm
- Resistant to use with seawater, being made from polypropylene and brass

Temperature of fluid:	+ 3° to 35°C
Ambient temperature:	40°
Max salt concentration:	
Operating mode:	S1

## DESIGN

### • Hydraulic part

Self-priming centrifugal pump.  
Pump body with priming chamber and inspection door, facilitating cleaning of the brass impeller.

Filling and draining plug.  
Suction check valve.

### • Electric motor

Speed:	2900 rpm
Winding:	230 V
Frequency:	50 Hz
Insulation class:	B
Protection index:	IP 44

## SECTIONAL DRAWING

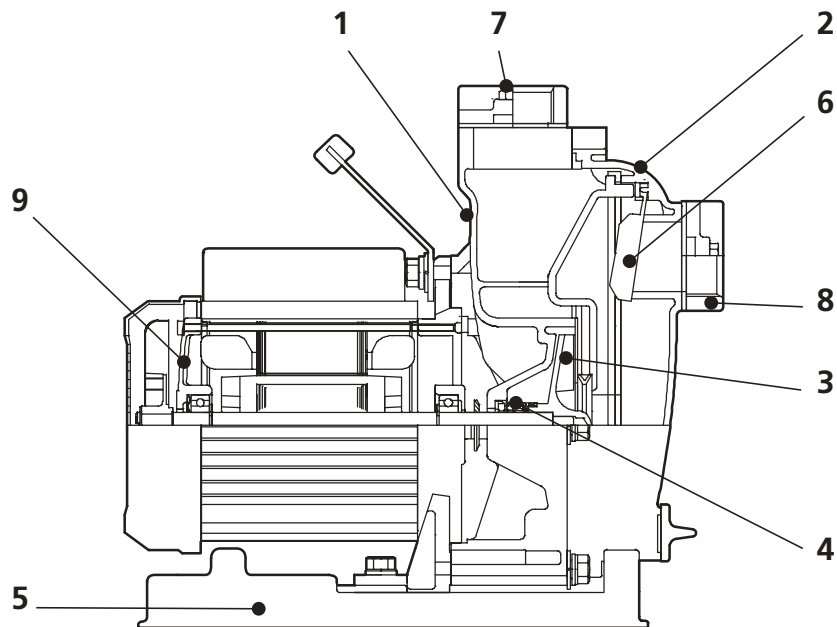

## PARTS LIST

- 1 Pump body
- 2 Inspection door
- 3 Motor
- 4 Terminal box
- 5 Leg
- 6 Draining plug
- 7 Mechanical seal
- 8 Impeller
- 9 Suction flange
- 10 Discharge flange
- 11 Seal
- 12 Check valve

(•) recommended spare parts

## DIMENSIONAL DATA

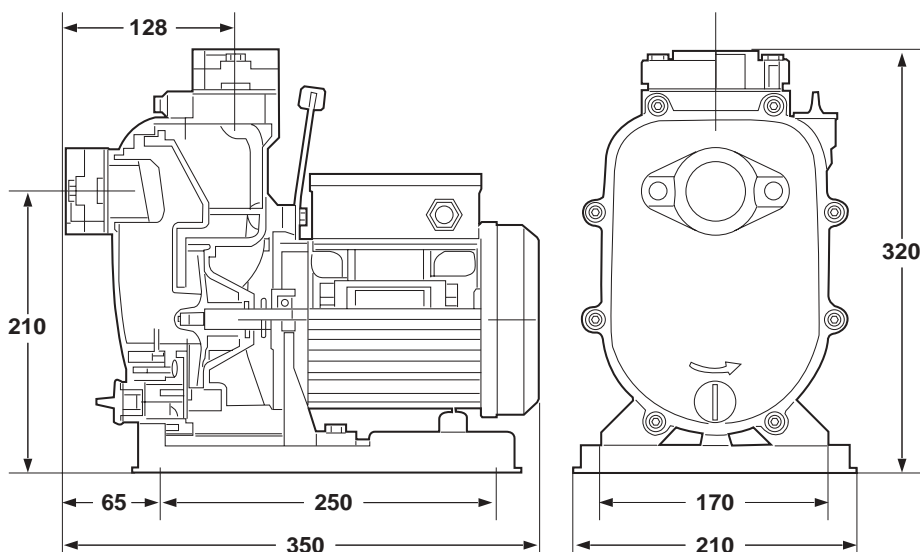

## STANDARD CONSTRUCTION

Main parts	Material
Pump body	Polypropylene + 30% glass fibre
Impeller	Brass
Check valve	NBR
Shaft	Two-metal: SM20C/STS 410
Mechanical seal	Carbon and ceramic
Leg	HDPE

## FEATURES

### a) Electrical

- 230 V – 50 Hz single-phase.
- Electric motor protection.

### b) Assembly

- Suction or flooded suction fixed or mobile installation.
- Fixed installation: mounting using the notches in the mounting leg.
- Mobile installation: the suction pipe must be secured if the suction head is  $> 4$  m.
- Connection through helix reinforced flexible piping.
- Strainer recommended (passage dia. 6 mm).

### c) Packaging

- Supplied ready-to-use and prewired with earth electrode and handle.

### d) Maintenance

- Repairing: see recommended spare parts (●) subject to wear.

## HYDRAULIC PERFORMANCES AT 2900 RPM

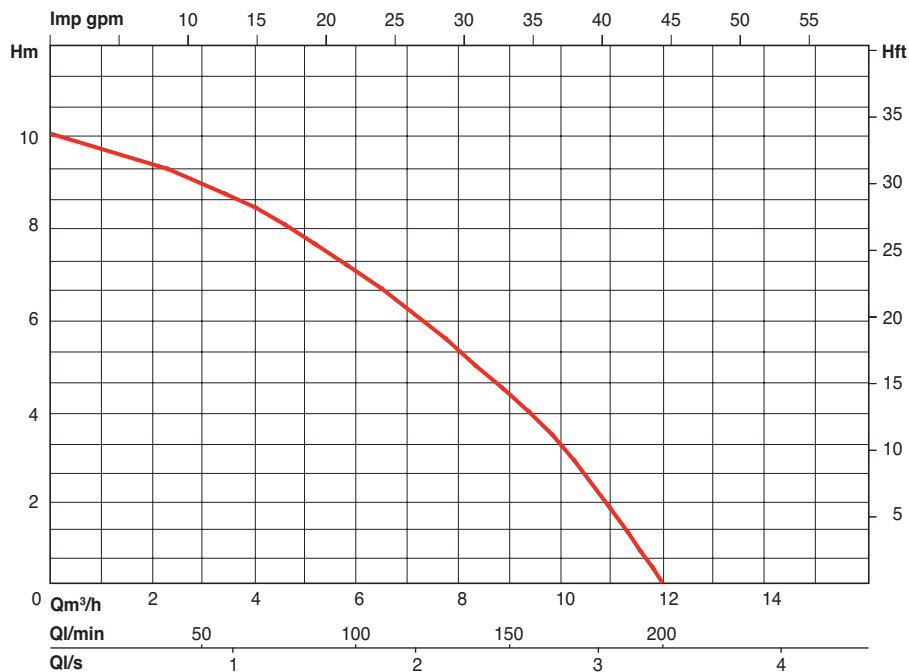

## INSTALLATION DIAGRAM

